



AIRGLAS INSTALLATION,
MAINTENANCE, SERVICE
INSTRUCTIONS & ILLUSTRATED PARTS
LIST (IMSIPL) MANUAL

MODEL L20500A SKI KIT

CODE IDENT NO. 17564

18 March, 2021

THIS MANUAL INCLUDES INFORMATION PROPRIETARY TO AIRGLAS, INC. AND SHALL
NOT BE USED TO MANUFACTURE OR REPRODUCE WITHOUT PERMISSION OF
AIRGLAS, INC.

AIRGLAS, INC
ANCHORAGE, ALASKA 99507

TABLE OF CONTENTS

Equipment & Materials	1
Section 1.0 Ski - Preparation Main Landing Gear	2
Section 2.0 Ski - Preparation Tail Landing Gear	2
Section 3.0 Helicopter - Preparation Main Landing Gear	2
Section 4.0 Helicopter - Preparation Tail Landing Gear	3
Section 5.0 Tail Ski - Installation	3
Section 6.0 Main Ski - Installation	4
Figure 1.0 Main Ski – Ski Preparation for Assembling to AH-64D	5
Figure 1.1 Main Ski – Ski Preparation for Assembling to AH-64D	6
Figure 2.0 Tail Ski – Ski Preparation for Assembling to AH-64D	7
Figure 3.0 Main Gear – Boeing Step and Plate Removal	8
Figure 3.1 Main Gear – Airglas Bracket and Step Assembly	9
Figure 3.2 Main Gear – Jack Pad Removal / Axle Assembly	10
Figure 5.0 Main Gear / Tail Gear – Pre-Install Ski Position	11
Figure 5.1 Main Ski – Axle Positioning and Assembly	12
Figure 5.2 Main Ski – Axle Positioning and Assembly	13
Figure 5.3 Main Ski – Spring Cylinder Positioning and Assembly	14
Figure 5.4 Main Ski – Check Cable Assembly	15
Figure 5.5 Main Ski – Safety Cable Assembly	16
Figure 5.6 Main Ski Check Cable Installation	17
Figure 6.0 Tail Ski – Axle Location and Assembly	18
Figure 6.1 Tail Ski – Axle Location and Assembly	19
Figure 6.2 Tail Ski – Spring Cylinder Positioning and Assembly	20
Figure 6.3 Tail Ski – Safety Cable Assembly	21
Section 7.0 Maintenance and Ground Handling Restrictions	22
Section 8.0 Maintenance Operational Checks	22
Section 9.0 Inspection Criteria	22
Section 10.0 Maintenance Tasks	23
Section 11.0 Ski Removal	30

EQUIPMENT AND MATERIALS

INITIAL SETUP

PERSONNEL REQUIRED

- One: AH-64 Helicopter Repairer
- One: Aircraft Structural Repairer
- Three: Assistants

TOOLS

- Aircraft Mechanic's Tool Kit
- Torque Wrench, 0 – 600 in. lbs,
GGG-W-686

MATERIALS/PARTS

- Corrosion Preventative Compound, MIL-C-16173D,
Grade 2
- Dry Cleaning Solvent, MIL PRF-680 Type II
- SuperLube Synthetic Grease (PTFE)
- Readily Available Anti-Seize agent
- Rag, Clean, DDD-T-541

LANDING GEAR SKIS - INSTALL MAIN AND TAIL

SKI - PREPARATION MAIN LANDING GEAR

Section 1.0

Preparation of both skis is the same except where noted.
Right side is shown.

1. Remove and save hardware (AN3-27A bolt, AN960-10 Washer, and AN365-1032 Nut) holding the Axle Assy., Outboard (L20500A-6) in place. *See figure 1.0*
2. Slide Axle Assy., Outboard out of fitting in ski. *See figure 1.0*
3. Remove Shipping Tube covering the Axle, Main Landing Gear (L20500A-7). *See figure 1.0*
4. Remove the Axle (L20500A-7) *See figure 1.0*
5. DO NOT REMOVE AXLE ASSY., INBOARD. *See figure 1.0*
6. Remove Tail Wheel Assembly and Check Cable from rear of the Main Ski by removing Elevator Bolts (EB616-20, EB616-21) from the bottom of the ski *See figure 1.1* Save all hardware for future use.

SKI - PREPARATION TAIL LANDING GEAR

Section 2.0

7. Remove Tail Wheel Bracket Kit (L20500-18) from back of Tail Ski Assy. (L20500A-3). Save all hardware for future use. *See Figure 2.0*
8. Remove Tail Ski Axle Adapter (L20500A-13). Save all hardware for future use *See Figure 2.0*

HELICOPTER - PREPARATION MAIN LANDING GEAR

Section 3.0

Preparation of both skis is the same except where noted.
Right side is shown.

9. Remove Step Assembly (7-511113527-1 & -2). Keep existing hardware for future use. *See figure 3.0.*
10. Remove Wire Cutter Assembly (443-83020-2). Keep hardware and wire cutter assy. for future use. *See figure 3.0*
11. Attach Airglas Bracket Assembly (L20500A-20 R.H., L20500A-21 L.H.) to Main Landing Gear using existing hardware *See Figure 3.1*
TORQUE VALUE
12. Bolt Bracket Assembly to Clamp (443-83023-1) (both sides) using existing hardware from Step 10. *See Figure 3.1*
13. Re-install Step Assembly (7-511113527-1 & -2) to Bracket Assembly (L20500A-20, L20500A-21) using existing hardware from Step 9. *See Figure 3.1 inboard*
14. Remove Jack Pad (1168321-1). Keep existing hardware. *See Figure 3.2*
15. Slide Axle, Main Landing Gear (L20500A-7) into the Trailing Arm (1168320-101) axle housing. *See Figure 3.2*
16. Line up clearance hole on Axle (L20500A-7) with clearance hole on Trailing Arm (1168320-101).
17. Re-install existing hardware from Step 14 to hold Axle (L20500A-7) in place. *See Figure 3.2*
TORQUE VALUE
18. Remove both inboard pylons.
19. Remove inboard attach bolts
20. Install check cable attach bracket PN L20500A-11-3, see fig. 5..6
21. Match torque of existing pylon bolts.
22. Set levelers to make full contact with side of pylon. Tighten NAS509-3C and safety the two nuts.

REMOVAL OF STEP AND WIRE CUTTER

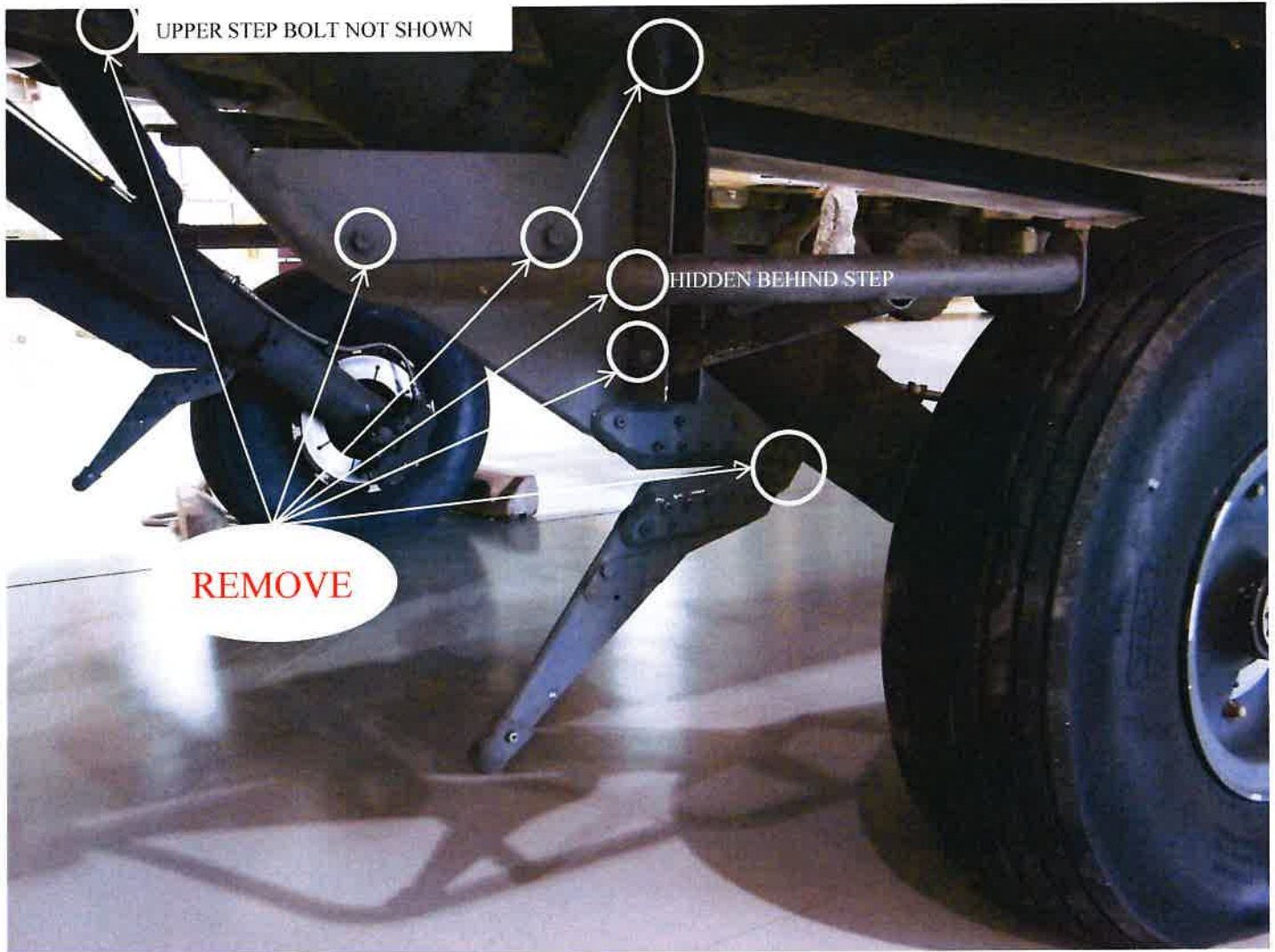

REMOVE HARDWARE CIRCLED IN PICTURE. NOTE: ONE OF THE FASTENERS IS HIDDEN BEHIND THE STEP, ONE (UPPER STEP BOLT) IS NOT IN PICTURE.

NOTE: RETAIN ALL HARDWARE FOR LATER USE.

INSTALLATION OF AIRGLAS ADAPTER ASSEMBLY (L20500A-20 RH SIDE, L20500A-21 LH Side)

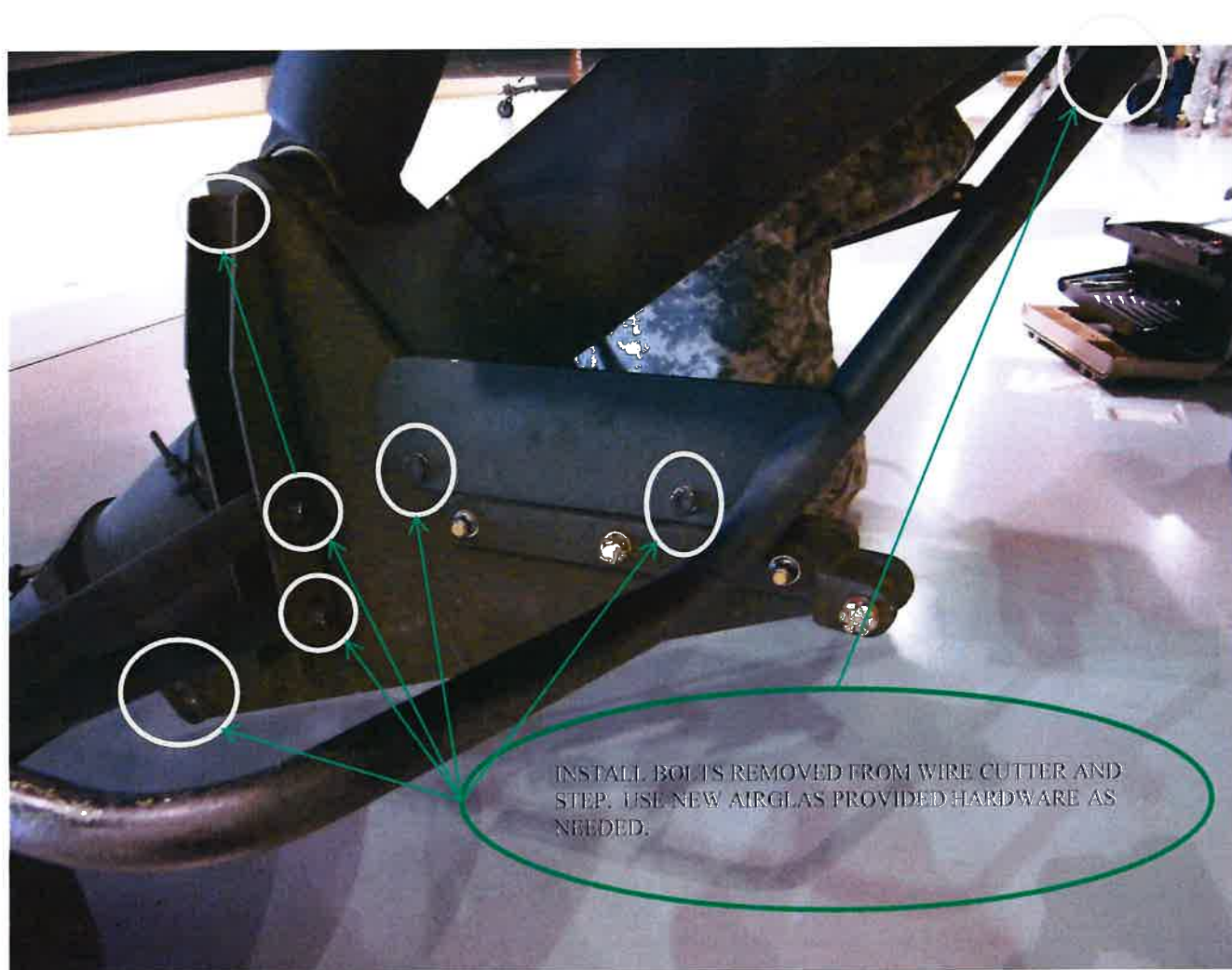

SEE FIG 3.1 FOR SPECIFIC DETAILS ON HARDWARE AND
TORQUE REQUIREMENTS

REMOVE JACK PAD



JACK PAD IS INSTALLED WITH ONE BOLT. REMOVE BOLT AND THEN TWIST AND PULL ON PAD TO REMOVE.

AFTER REMOVAL OF JACK PAD, CLEAN THE INTERIOR OF THE AXLE CAVITY TO REMOVE ALL FOREIGN MATERIAL. USE OF A ROUND (BORE) BRUSH AND SHOP AIR WILL BE NEEDED.

INSERT L20500A-7 AXLE INTO MAIN LANDING GEAR
AXLE CAVITY.

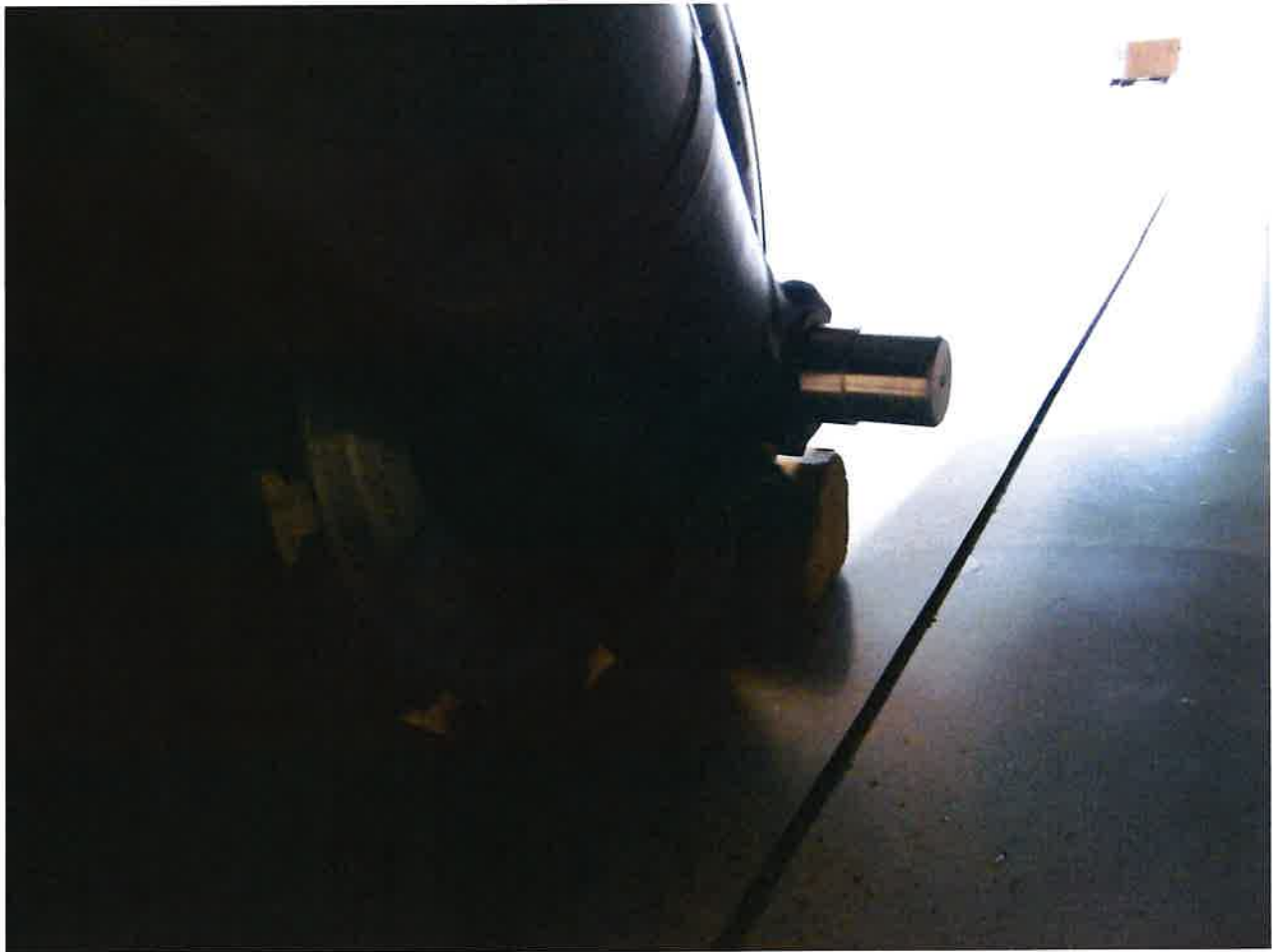

INSERTION OF THE AIRGLAS L20500A-7 AXLE CAN HAVE BE COMPLICATED BY PAINT OVERSPRAY INSIDE AXLE CAVITY. BOEING DID NOT SPECIFY A PAINT THICKNESS IN THIS AREA. DO A TEST INSERTION TO SEE HOW FAR AXLE WILL GO IN WITH NO FORCE. IF IT DOES NOT GO IN ALL THE WAY, TAP LIGHTLY WITH A RUBBER Mallet.

NOTE: BE SURE TO ALIGN HOLES OF THE AIRGLAS AXLE (L20500A-7) AND THE MAIN LANDING GEAR AXLE.

YOU MAY NEED TO DO A SERIES OF INSERTIONS AND PAINT CHIP REMOVAL TO GET AXLE TO GO ALL THE WAY IN. IF YOU SEE ANY METALLIC CHIPS, STOP AND HAVE IT ASSESSED BY A TECHNICAL EXPERT.

HELICOPTER - PREPARATION TAIL LANDING GEAR

Section 4.0

23. Remove Wire Strike (Deflector) from Tail Landing Gear and all associated hardware.

NOTE: The bolts that attach wire strike to tail wheel axle will need to be replaced with NAS6405-32 bolts, or an alternate temporary method by using a washer stack added to replace the thickness of the wire strike attach lugs. Washers should be replaced at the next major maintenance inspection. These bolts are in shear, so washer stack has no impact on joint strength.

TAIL SKI - INSTALLATION

Section 5.0

24. Remove Bolts (AN4-7A), Washers (AN960-416), and Nuts (A365-428), (and NAS70C-4 Washers) holding tail ski, Tail Wheel Bracket Kit (L20500-18) to ski and remove Tail Wheel Bracket Kit. *See Figure 2.0* (retain hardware)

Note: Remove the L20500A-14-2 bracket (Item 38 of IPB on Page 28) prior to towing helicopter onto tail ski. This bracket will create interference with tow bar. This is done by removing the two AN5-12A bolts and one AN3-21A bolt (Item 8 & 41 on page 28) attaching bracket to the L20500A-14 (Item 22 on page 28)

25. Center Tail Ski in front of Tail Gear Wheel. *See Figure 5.0*
- 26.. Tow helicopter, or push helicopter forward, with help of assistants, until Tail Wheel is centered in Ski Wheel Well.
27. Lift rear ski so the Tail Ski Attach Brackets (L20500A-14) line up with the Tail Wheel Axle (1168819-1). *See Figure 6.0*

Note: Re-install the L20500A-14-2 bracket (Item 38 of IPB on Page 28) attaching bracket to the L20500A-14 (Item 22 on page 28) This is done by installing the two AN5-12A bolts and one AN3-21A bolt (Item 8 & 41 on page 28) removed in Step 24 above. Torque AN5-12A to 100-140 IN LBS, the AN3-21A to 20-25 IN LBS.

28. Insert Tail Ski Axle Adapter(s) (L20500A-13) through Ski Attach Bracket(s), place Axle Spacer(s) (L20500A-16) on Tail Ski Axle Adapter(s). *See Figure 6.0*
29. Push Ski Axle Adapter (s) into Tail Ski Axle until clearance holes line up on Ski Attach Bracket(s) and Ski Axle Adapter (s). *See Figure 6.1*
30. Insert Bolt(s) (AN3-14A) through clearance holes, affix Washer(s) (AN960-10) and Nut(s) (AN365-1032). *See Figure 6.1* TORQUE VALUE
31. Attach Spring Cylinder, Tail Ski (L20500A-15) to Tail Ski, Lower Attach Fitting (L20500A-19) with Bolt (AN26-21), Washer (AN960-616L) and Nut (AN320-6). Secure Nut with Cotter Pin (MS24665-302). *See Figure 6.2* TORQUE VALUE
32. Insert Bushings (L20500A-22) into 3/8 hole in Eye Bolt, SPL (L20500A-23) one from each side. *See Figure 6.2*
33. Hold the Spring Cylinder in one hand, lift the front of the ski, and position the upper Eye Bolt (L20500A-23) so that the Eye Bolt is lined up with the Bushings and tlg wheel fork assy lugs 1168850. Insert Eye Bolt (L20500A-24) Affix Washer (AN960-416) and Nut (AN310-4). Instl MS24665-151 cotter pin. *See Figure 6.2*
34. Install Safety Cable Tail Ski (L20500A-17) onto Tail Ski using Washer (30185), Screw (NAS514P524-16), Washer (AN960-516) and Nut (AN365-524). *See Figure 6.3* TORQUE VALUE
35. Attach upper portion of Safety Cable to Eye Bolt (L20500A-24) using Clevis Pin (AN394-15) and Cotter Pin (MS24665-151). *See Figure 6.3*
36. Re-Install Tail Wheel Bracket Kit (L20500-18). *See Figure 2.0*

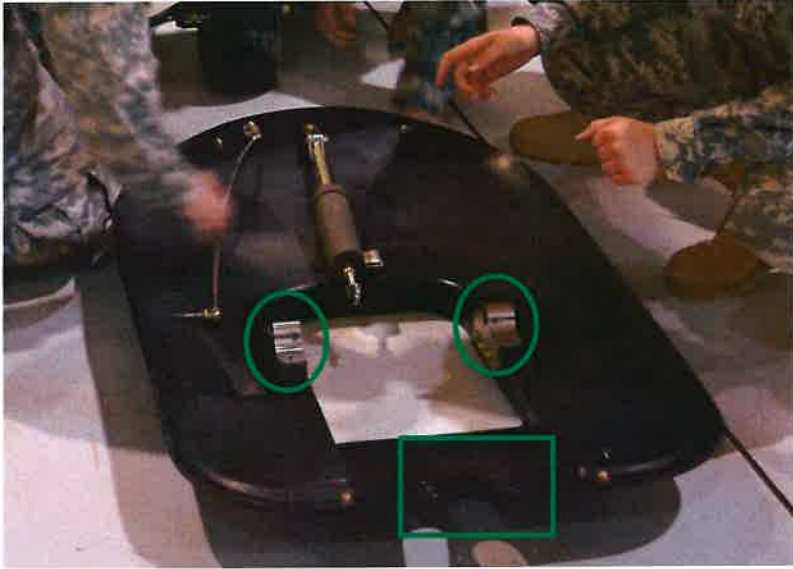

Tail ski with L20500A-14-2 Tow Bar Adapters and L20500-18 tail wheel assembly removed



Tail ski with L20500A-14-2 Tow Bar Adapters reinstalled and connected to tow bar.



Tail ski with L20500A-14-2 Tow Bar Adapters reinstalled and L20500-18 tail wheel assembly being installed.

LANDING GEAR SKIS - INSTALL MAIN AND TAIL

MAIN SKI - INSTALLATION

Section 6.0

37. Center Main Skis in front of Main Landing Gear Wheels *See Figure 5.0*
38. CAUTION – To avoid damage to ski take extreme care to ensure that the wheels are on the outboard part of the wheel wells.
39. Install Airglas installation ramps on both main skis.
40. Tow helicopter or push helicopter forward with help of assistants until the main wheels are centered in the ski wheel well.
41. Lubricate Axle, Main Landing Gear (L20500A-7) with thin coat of Synthetic Grease (PTFE).
42. Lift tail of main ski off the ground and slide fore or aft to align the Axle Assembly, Inboard (L20500A-5) (which was left on the ski) with the Axle, Main Landing Gear (L20500A-7). Slide ski outboard until Axle (L20500A-7) is properly seated in Inboard Axle (L20500A-5). *See Figure 5.1*
43. Coat Axle Assy., Outboard (L20500A-6) threads with anti-seize agent. Coat Axle Assy., Outboard (L20500A-6) body with corrosion preventative compound, MIL-C-16173D, Grade 2.
44. Insert Axle Assy., Outboard (L20500A-6) into Main Ski Bushing Assy. (L20500-4) and thread Ski Axle into Ski Bushing. *See Figure 5.1*
45. Thread Inboard and Outboard Ski Axles until both are evenly seated on Axle, Main Landing Gear (L20500A-7). *See Figure 5.2*
46. Back off Inboard and Outboard Ski Axles until the holes line up to slots on the Ski Bushing.
47. Install bolt(s) (AN3-27A) through Inboard and Outboard Axles and Ski Bushing. Affix Washer(s) (AN960-10) and Nut(s) (AN365-1032) onto bolt(s) *See Figure 5.2*. TORQUE NUTS TO 20 – 25 INCH-POUND.
48. Install Spring Cylinder, Main Ski (L20500A-8) on forward Ski Eye Bolt (AN47-14) with Clevis Bolt (AN396-23) and Cotter Pin (MS24665-302) and to the Upper Mounting Bracket (L20500A-21-3) with Clevis Bolt (AN26-25), (2) Washers (AN960-616L) and Nut (AN320-6), (4) Special Washers (P/N 528D378D050 (2 each side of rod end)). *See Figure 5.3* TORQUE VALUE
49. Install Check Cable (L20500A-11) to check cable bracket, PN L20500A-11-3 using Clevis Pin and Cotter Pin.
50. Re-Install Tail Wheel Assembly (L20500-D501A) *See Figure 1.1*
51. Align Check Cable to Ski Angle Bracket (L20500A-11-1A, L20500A-11-1B), Insert Clevis Pin (AN396-23) and Cotter pin (MS24665-302). *See Figure 5.4*
52. Install lower end of Safety Cable Assy. (L20500A-12) to ski with Bolt (AN5-6A) Washer (AN960-516L) Nut (AN365-524). *See Figure 5.5*. TORQUE VALUE Install upper end to Eye Bolt (AN45-11) at 2nd hole back on Bracket Assy. (P/N L20500A-20, L20500A-21) Fasten with clevis pin (AN395-17) and secure with cotter pin MS249665-302. *See Figure 5.5*.

MAIN SKI – SKI PREPARATION FOR ASSEMBLING TO AH-64D

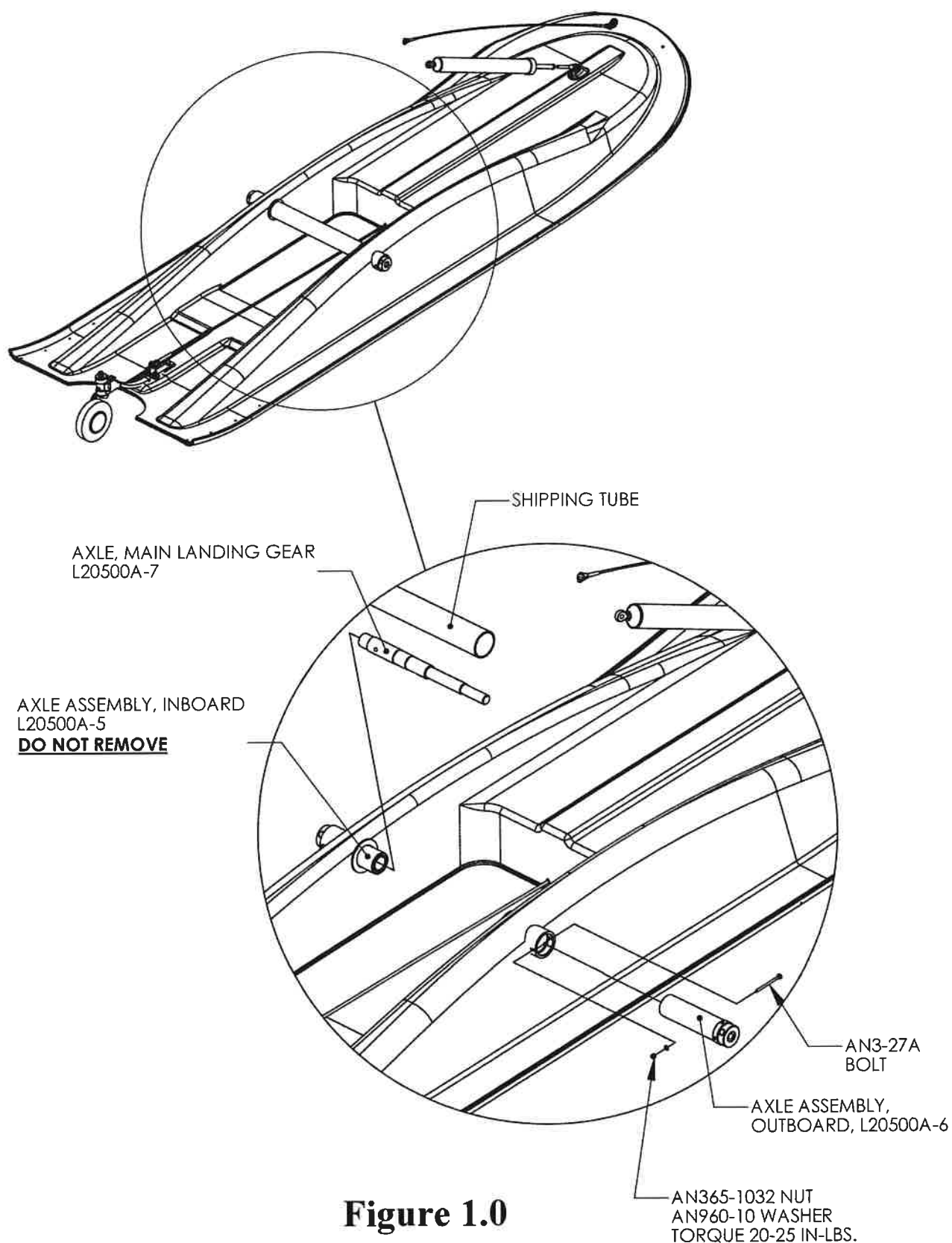

Figure 1.0

MAIN SKI – SKI PREPARATION FOR ASSEMBLING TO AH-64D

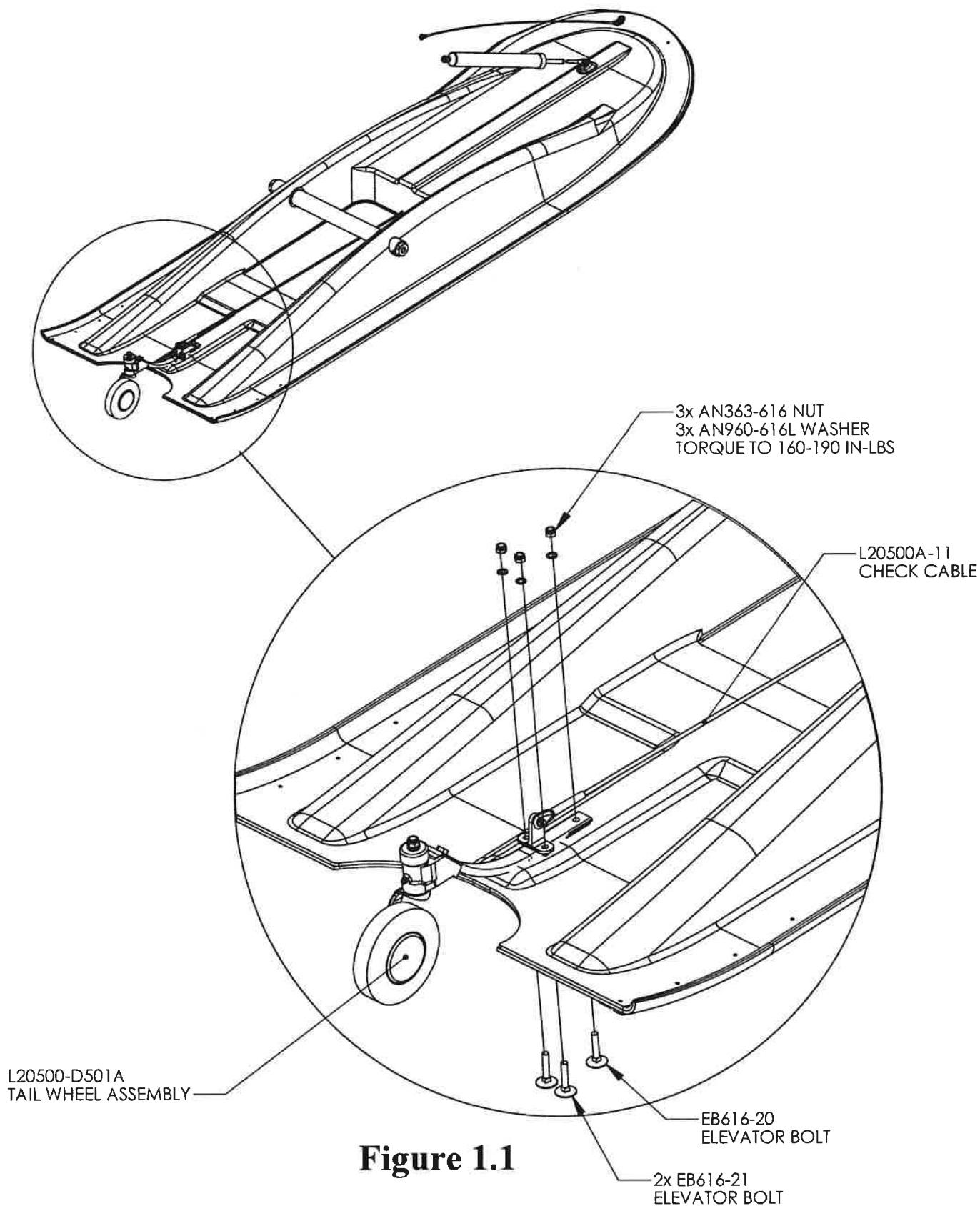

Figure 1.1

TAIL SKI – SKI PREPARATION FOR ASSEMBLING TO AH-64D

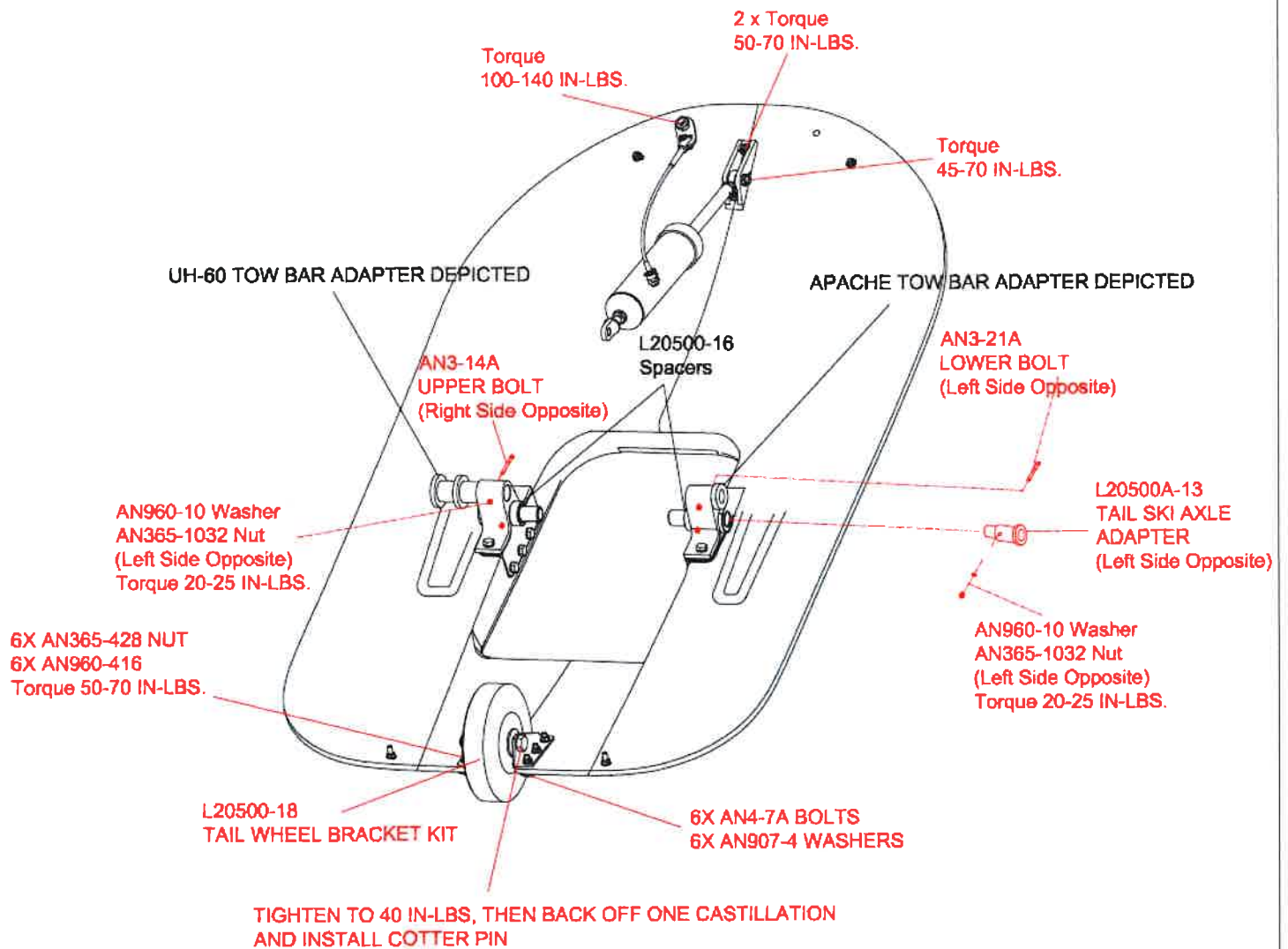

FIGURE 2.

MAIN GEAR – BOEING STEP AND PLATE REMOVAL

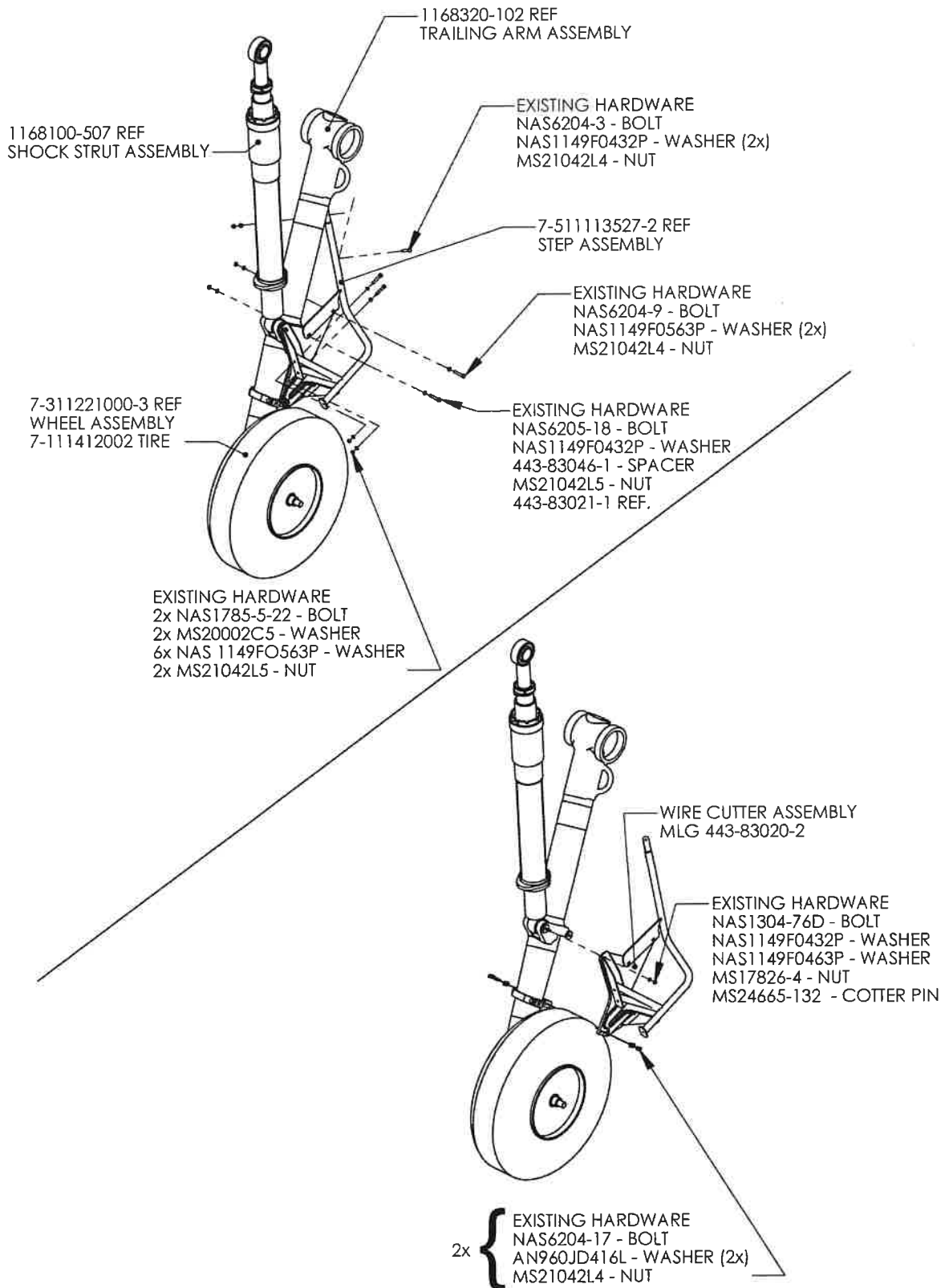

Figure 3.0

MAIN GEAR – AIRGLAS BRACKET AND STEP ASSEMBLY

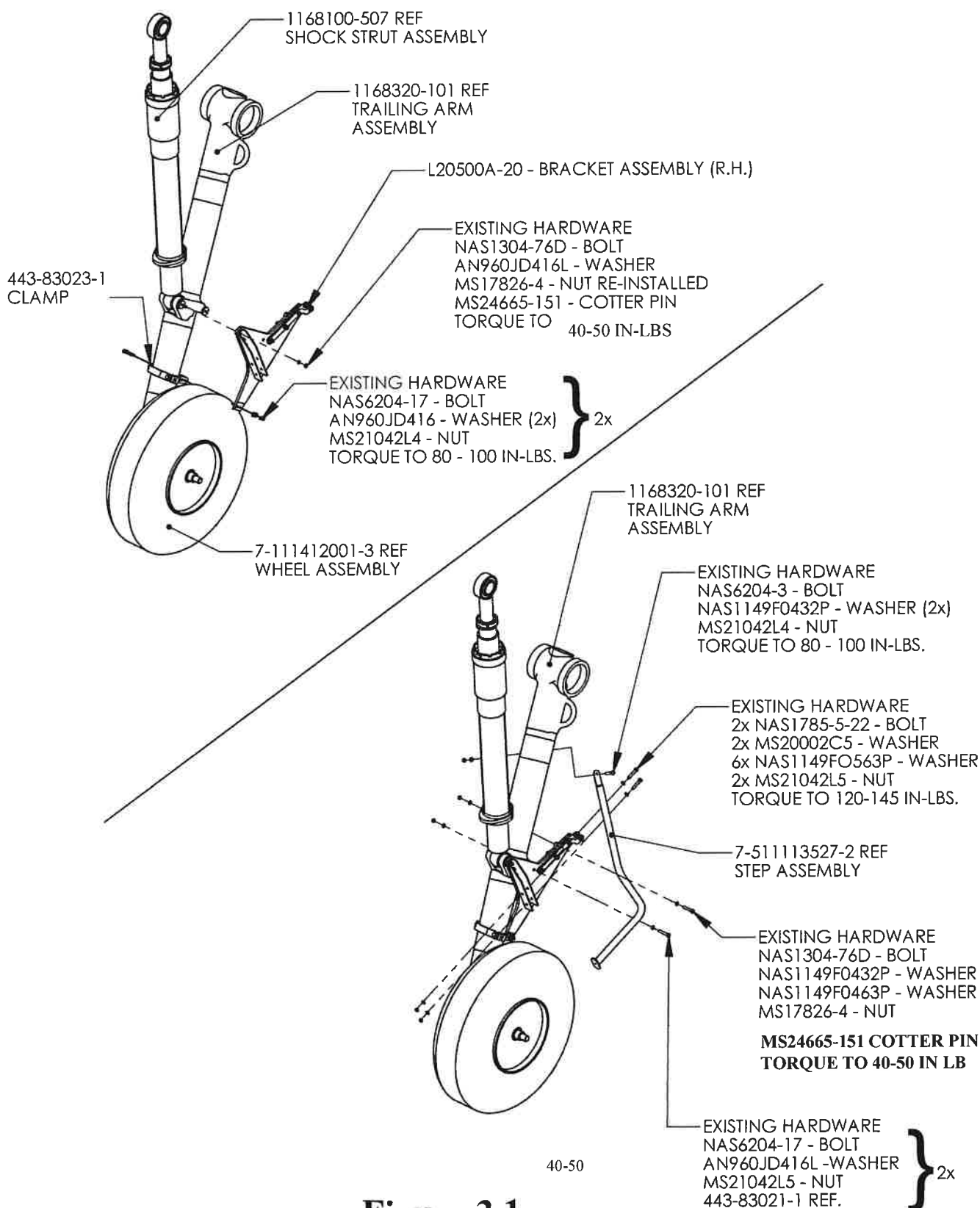

Figure 3.1

MAIN GEAR – JACK PAD REMOVAL / AXLE ASSEMBLY

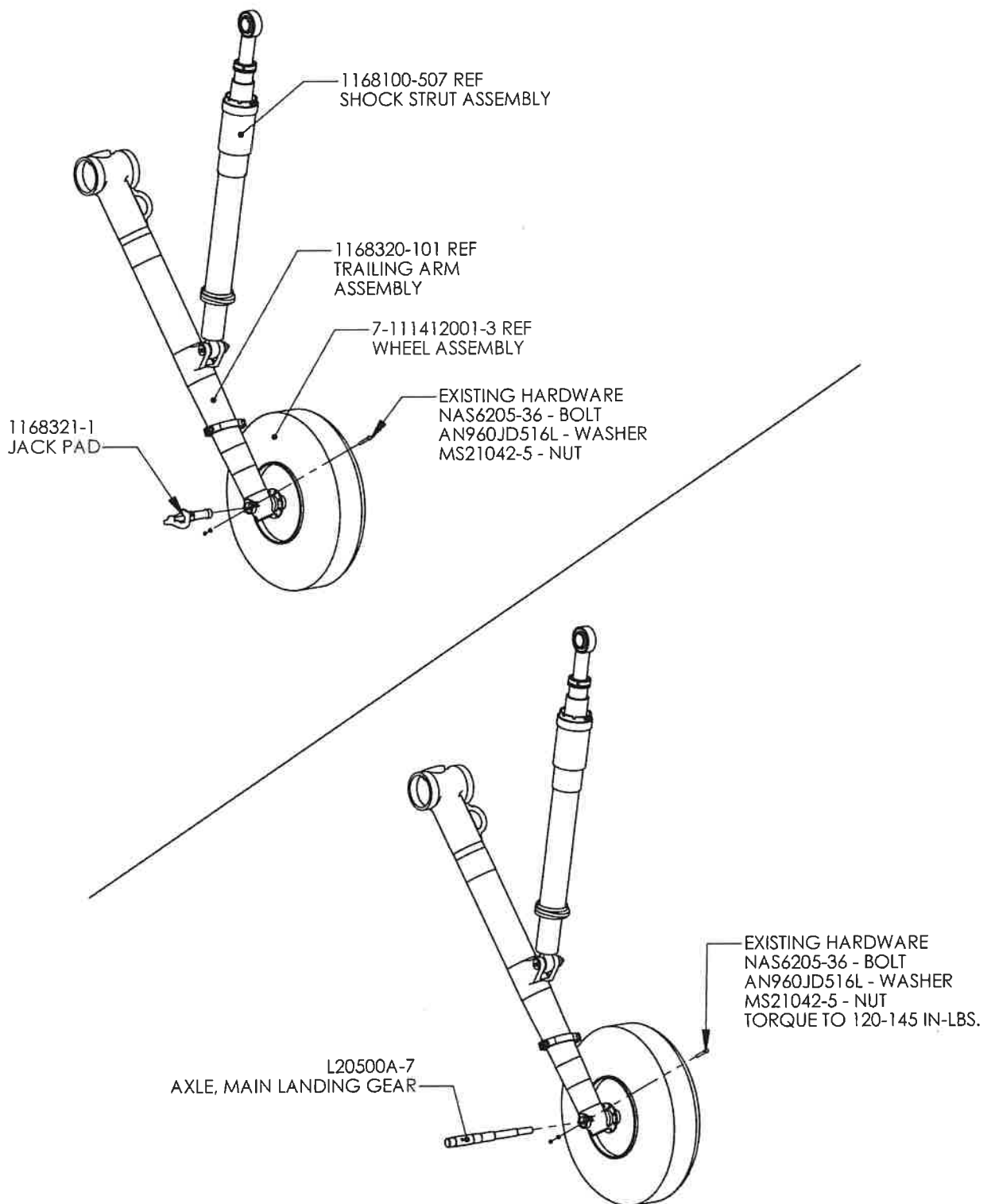

Figure 3.2

MAIN GEAR / TAIL GEAR – PRE-INSTALL SKI POSITION

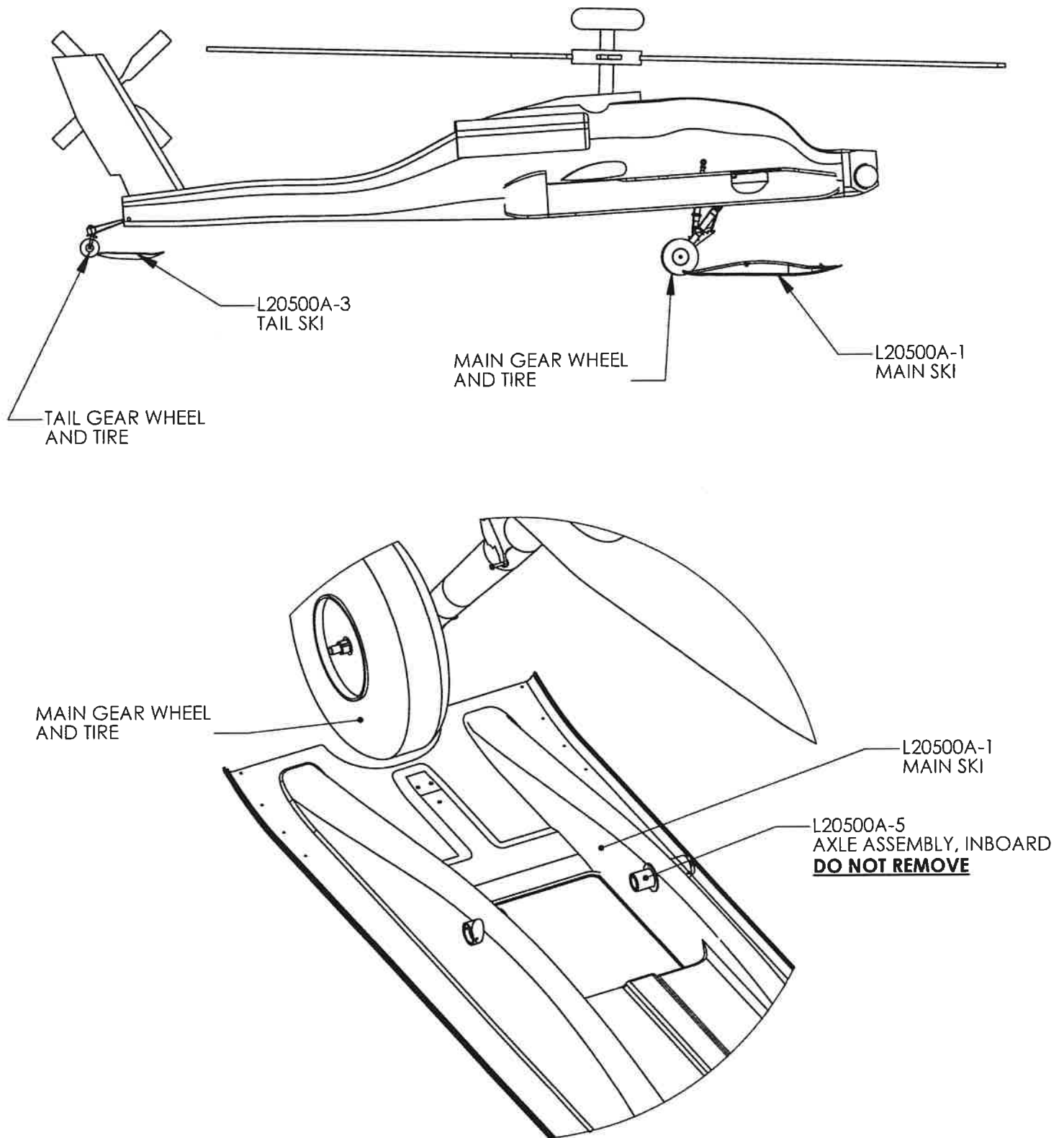

Figure 5.0

11

AIRGLAS, INC
ANCHORAGE, ALASKA 99507

MAIN SKI – AXLE POSITIONING AND ASSEMBLY

MOVE SKI FORE OR AFT TO ALIGN
AXLE ASSEMBLY, INBOARD (L20500A-5)
WITH AXLE, MAIN LANDING GEAR (L20500A-7)

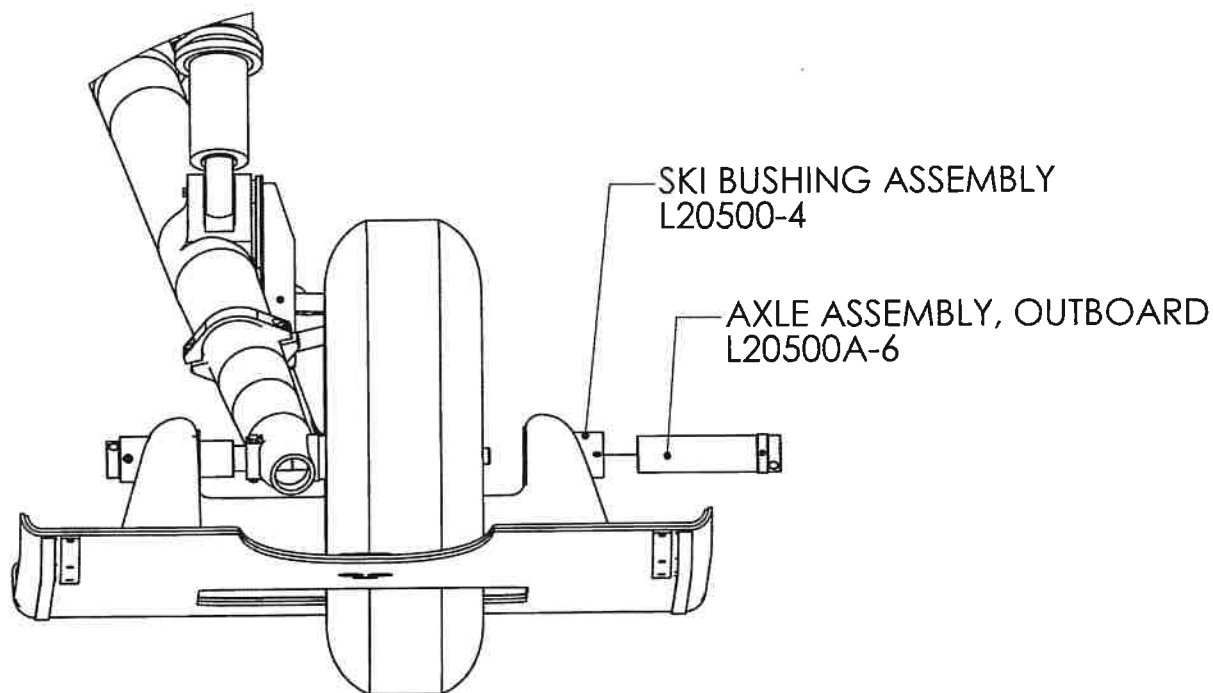
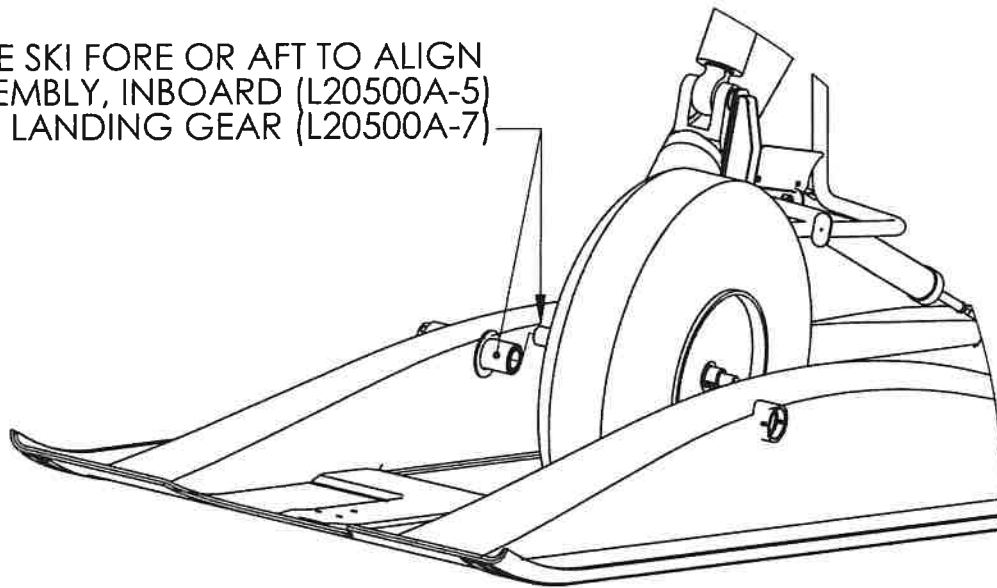

Figure 5.1

MAIN SKI – AXLE POSITIONING AND ASSEMBLY

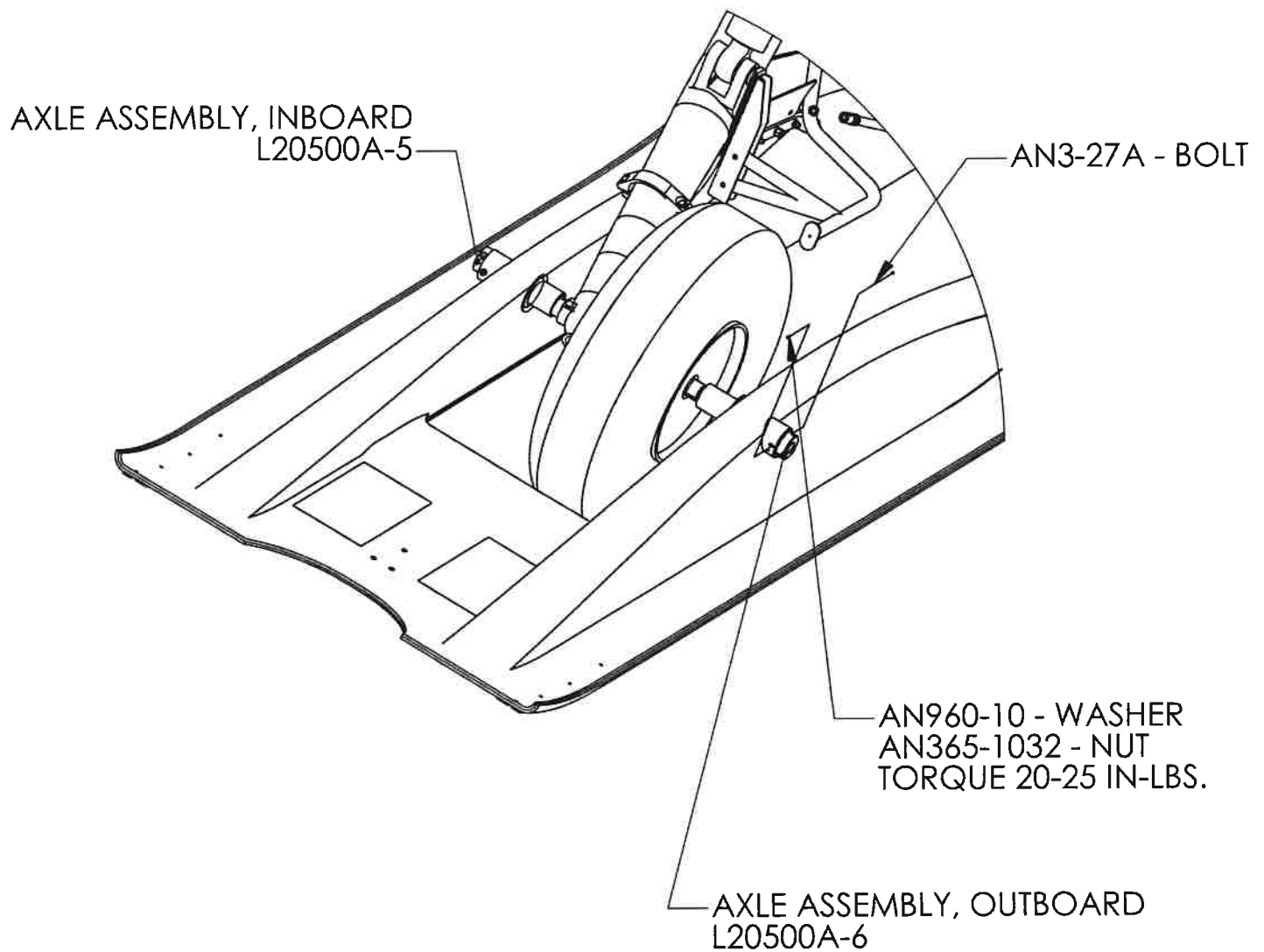

Figure 5.2

MAIN SKI – SPRING CYLINDER POSITIONING AND ASSEMBLY

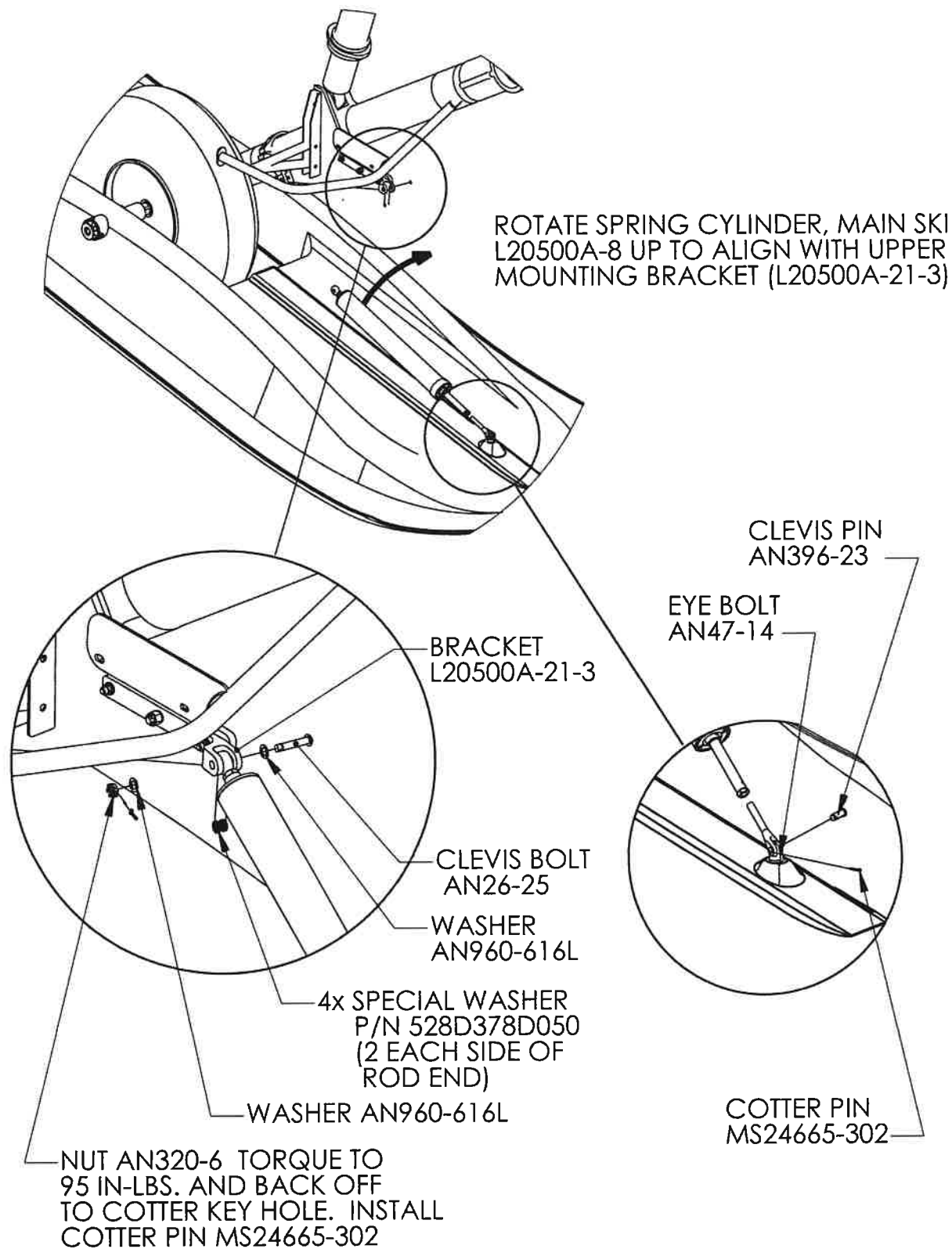

Figure 5.3

MAIN SKI – CHECK CABLE ASSEMBLY

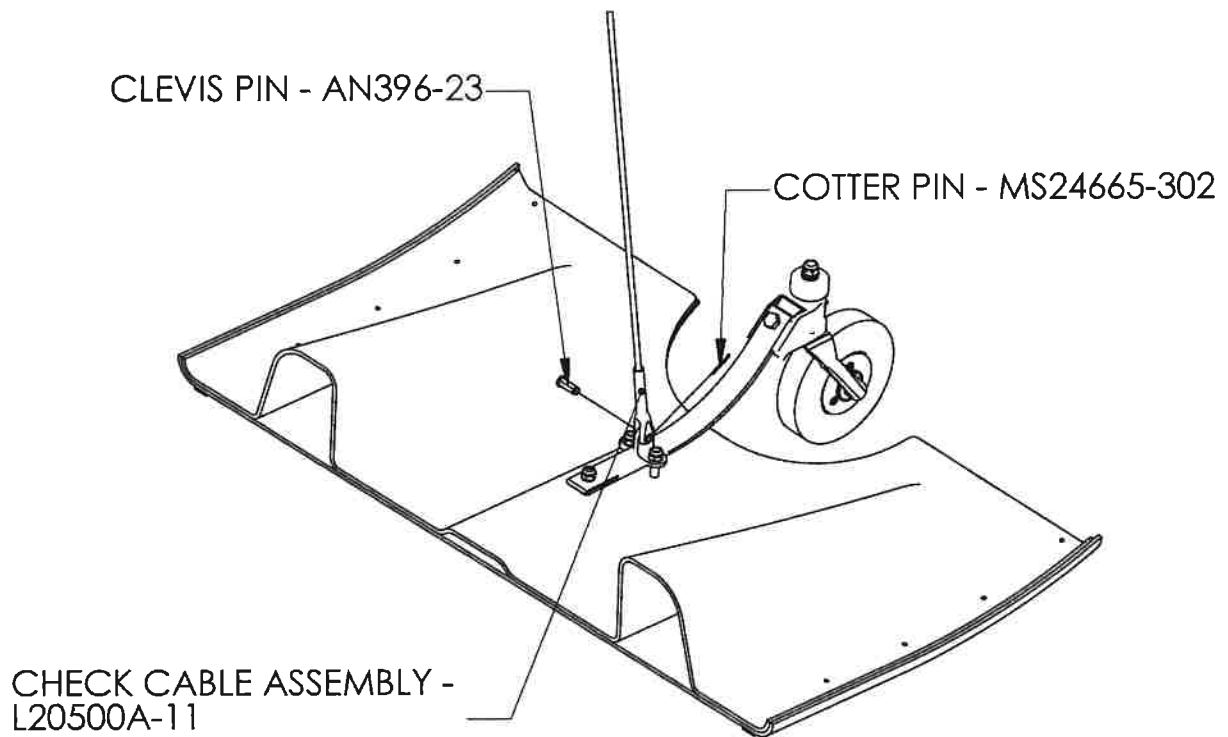

Figure 5.4

MAIN SKI – SAFETY CABLE ASSEMBLY

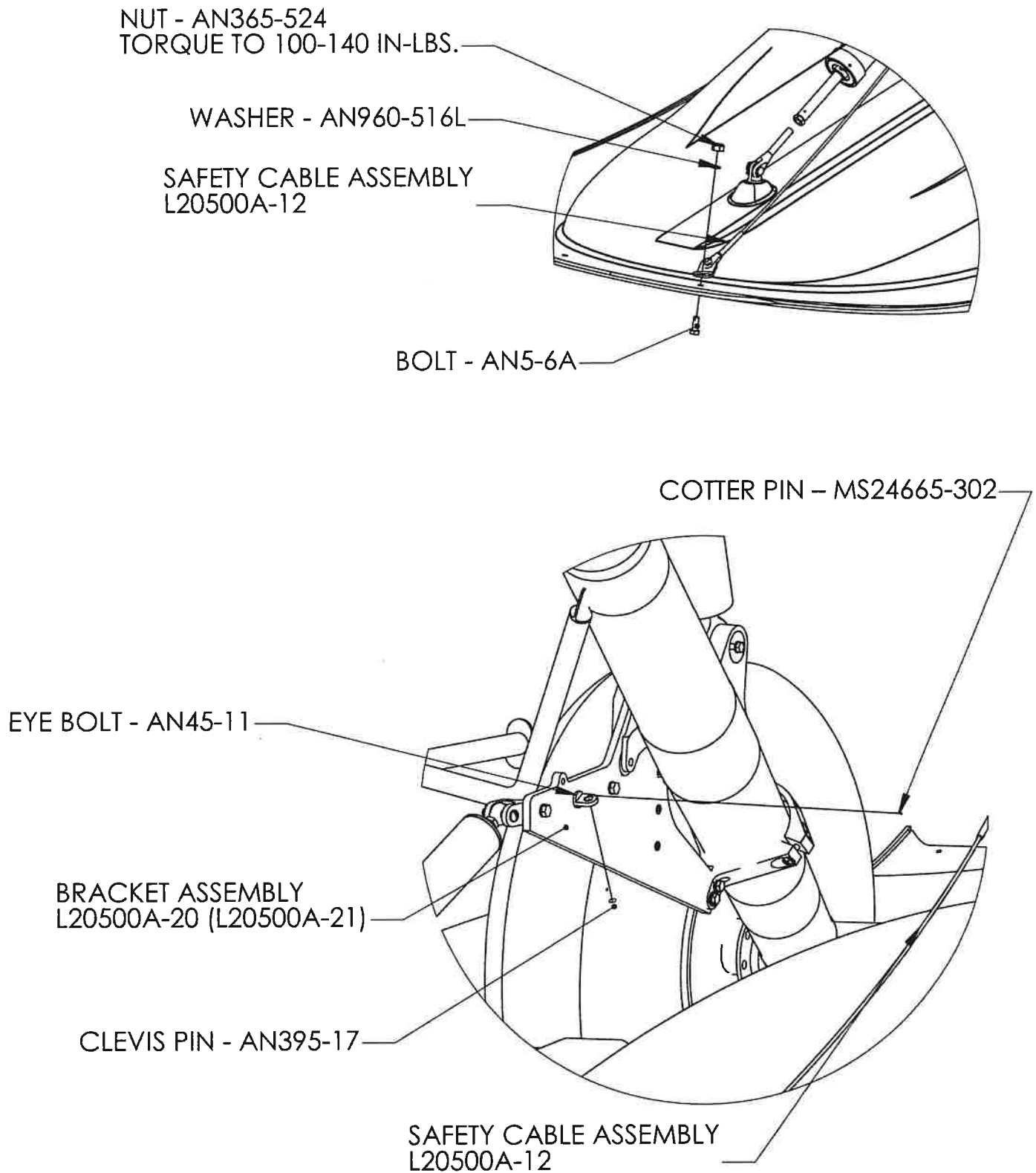

Figure 5.5

PYLON CHECK CABLE BRACKET INSTALL

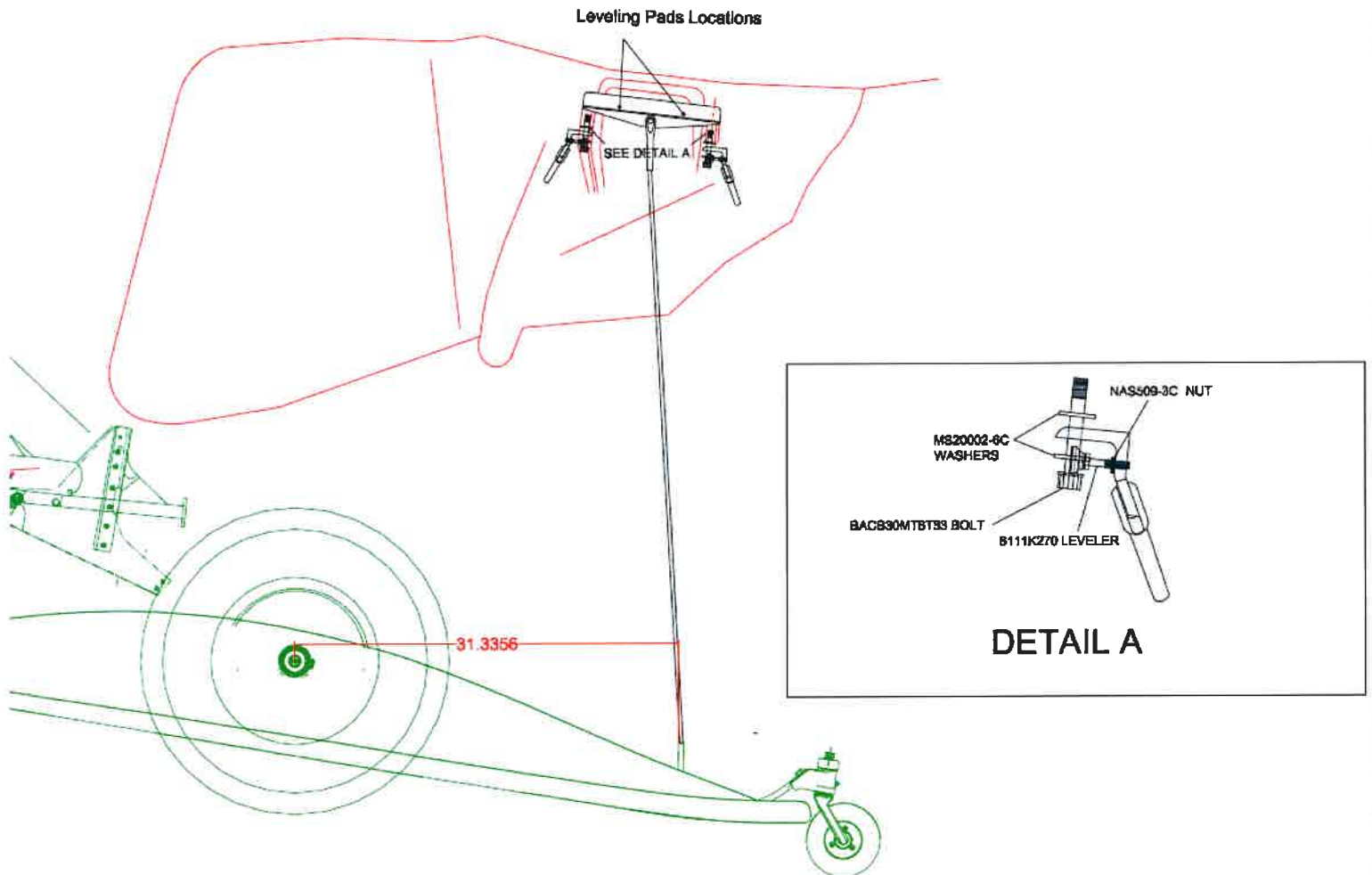

FIGURE 5.6

TAIL SKI – AXLE LOCATION AND ASSEMBLY

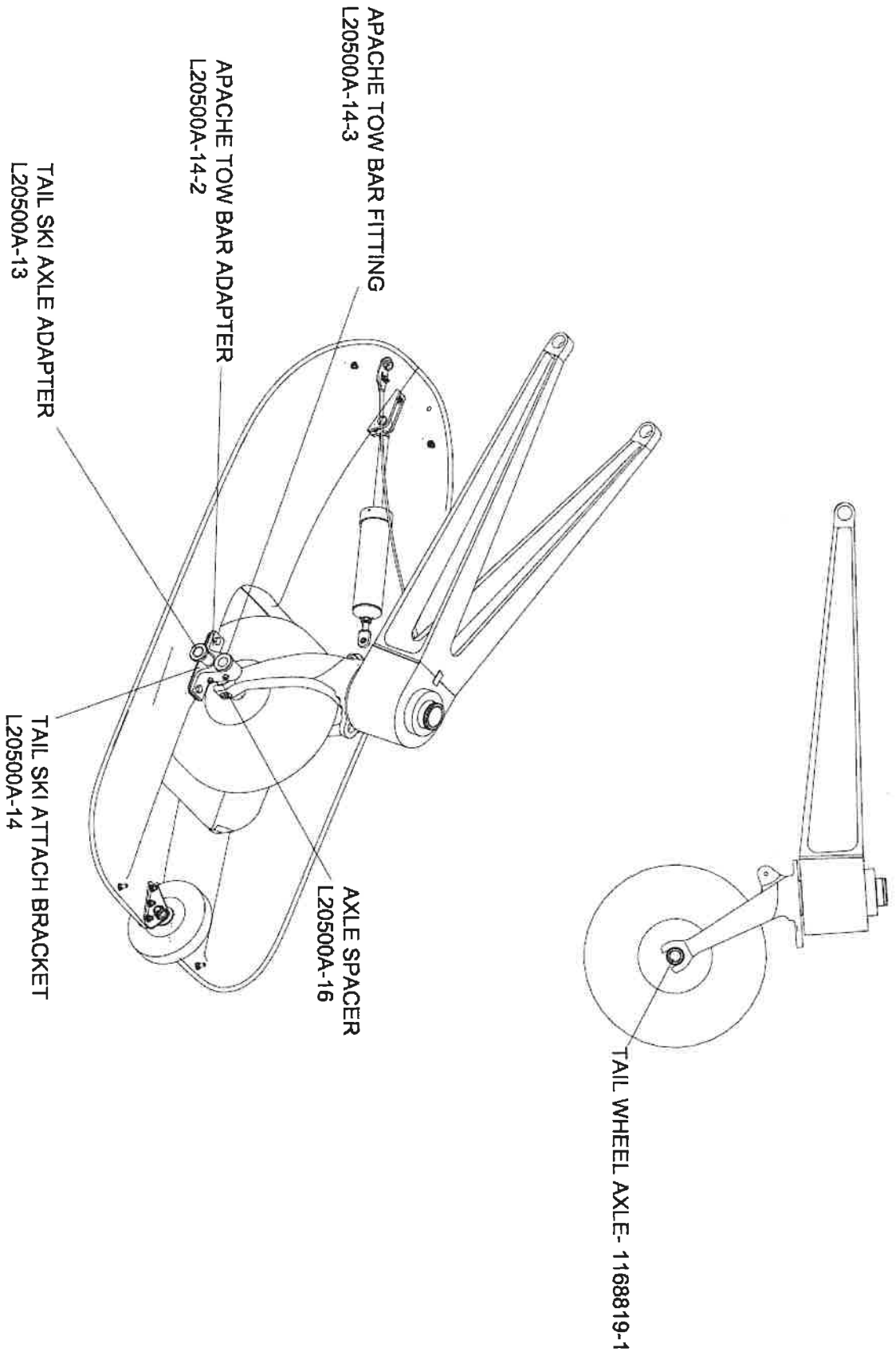

FIGURE 6.0

TAIL SKI – AXLE LOCATION AND ASSEMBLY

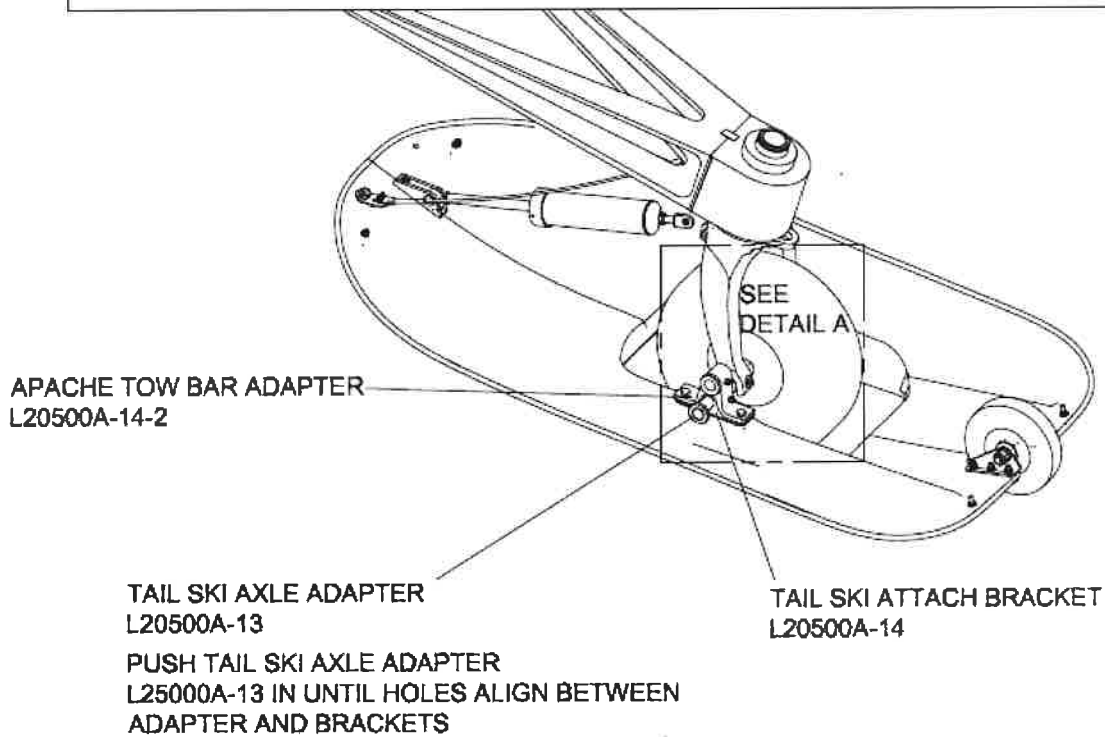
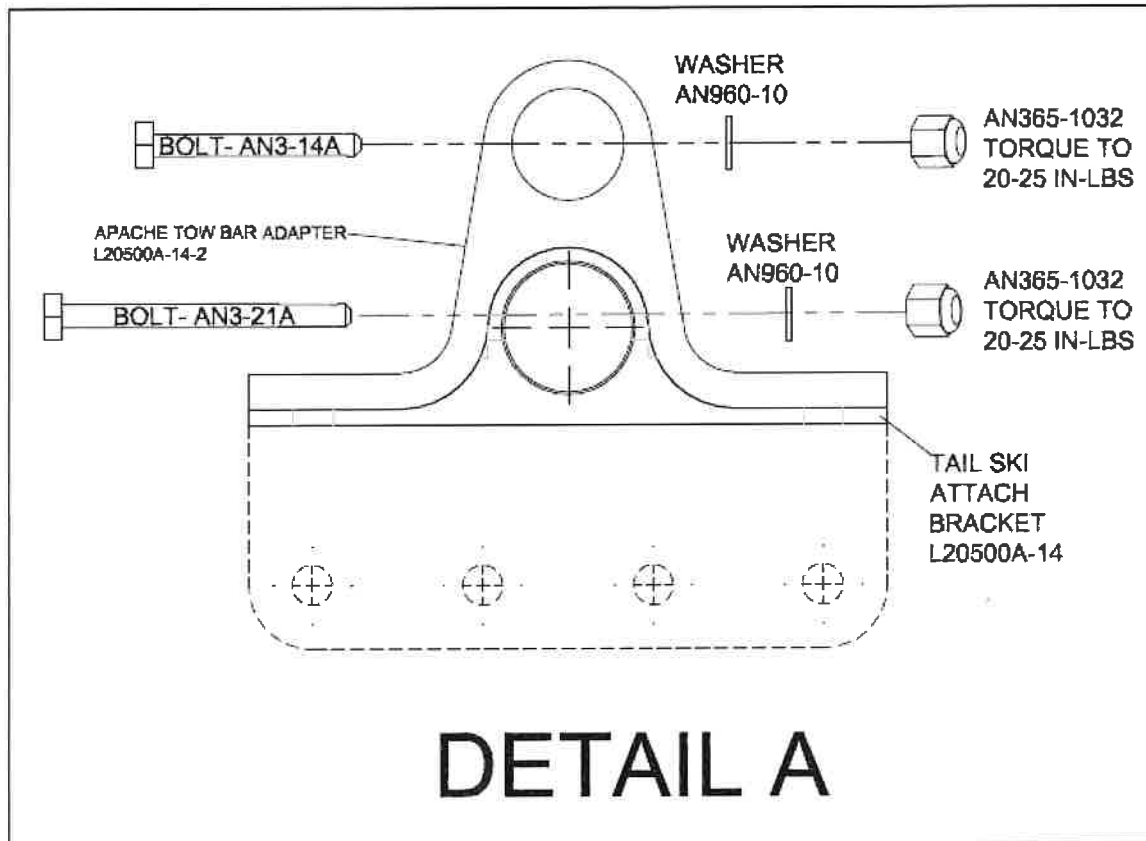

FIGURE 6.1

TAIL SKI – SPRING CYLINDER POSITIONING AND ASSEMBLY

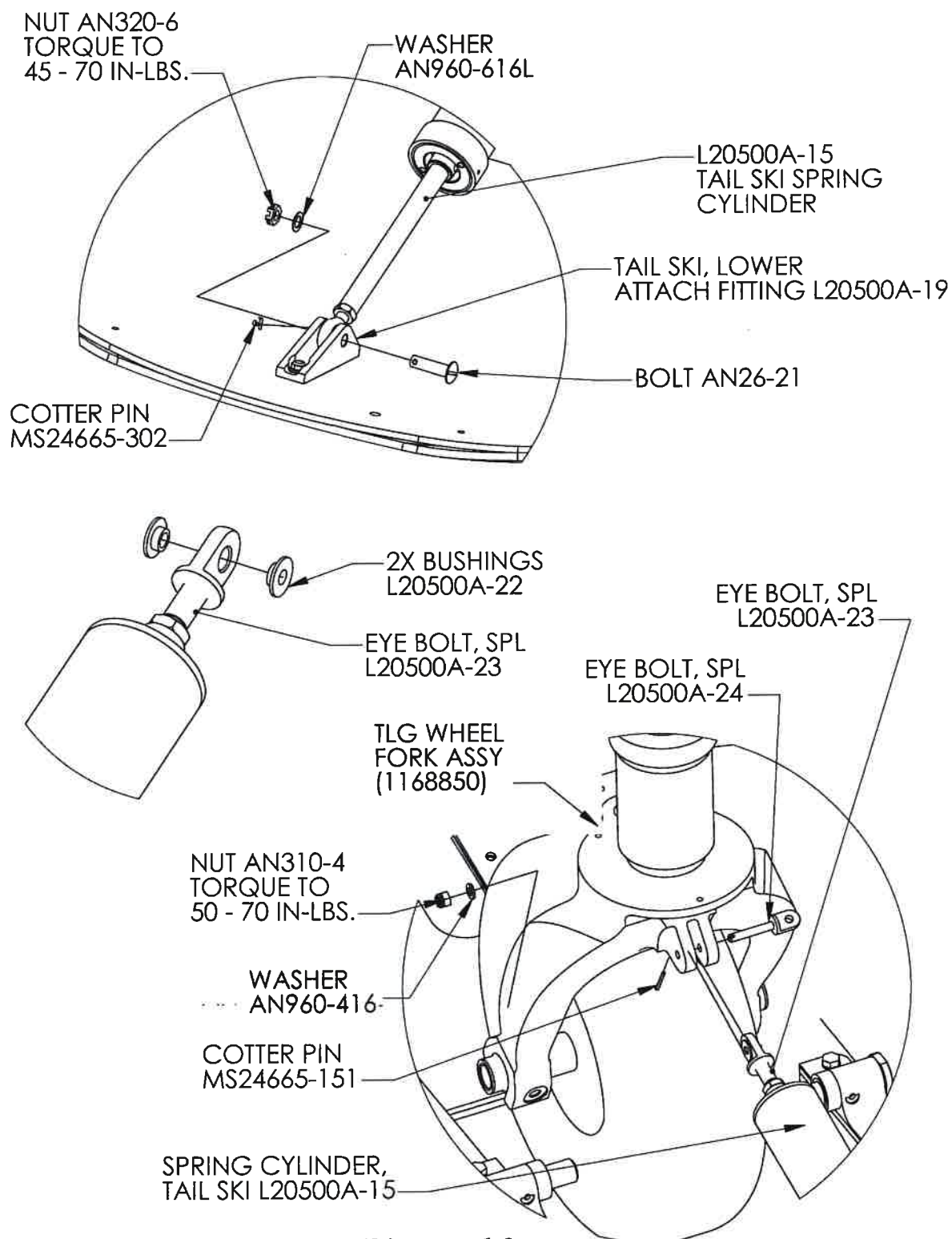

Figure 6.2

TAIL SKI – SAFETY CABLE ASSEMBLY

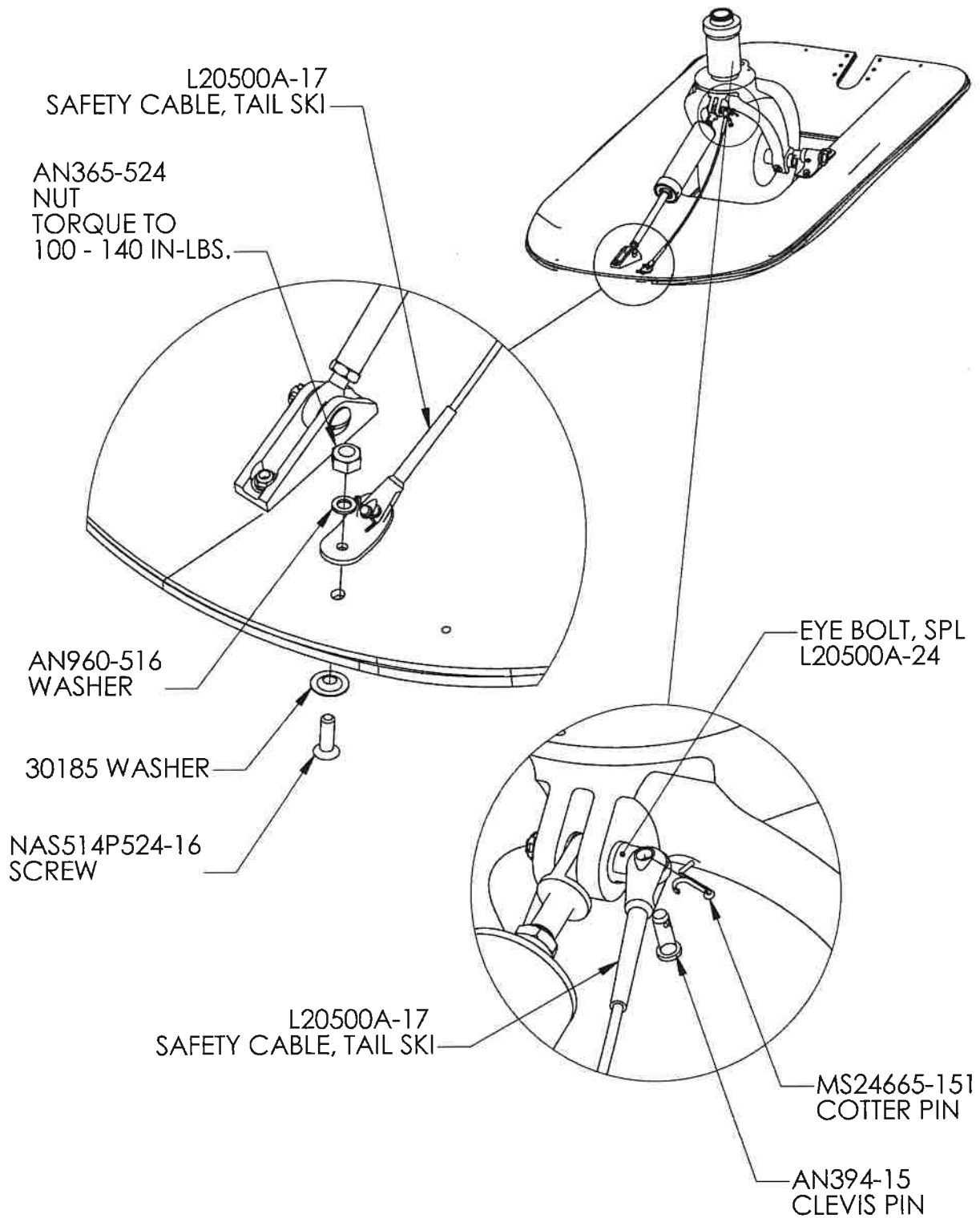

Figure 6.3

MAINTENANCE AND INSPECTION CRITERIA

Section 7.0 MAINTENANCE AND GROUND HANDLING RESTRICTIONS

1. **DO NOT** – Push or Pull on skis to move aircraft
2. **DO NOT** – Subject to flame or high heat
3. **DO NOT** - Attempt to jack aircraft with skis installed
4. **DO NOT** – Subject to harsh solvents or caustic chemicals
5. **DO NOT** – Use skis as a tie down for the aircraft
6. **DO NOT** – Disassemble the Main Ski Spring Cylinder (Airglas Part No.# L20500A-8)
7. **DO NOT** – Disassemble the Tail Ski Spring Cylinder (Airglas Part No.# L20500A-15)
8. **DO NOT** – Attempt to change a main gear tire with the skis installed
9. **DO NOT** – Attempt to change a tail gear tire with the skis installed
10. **DO NOT** – Use standard wheel chocks with skis installed

Section 8.0 MAINTENANCE OPERATIONAL CHECKS

10-14 Check (10 hour or 14 day inspection)

1. **CHECK** – Force required to move main ski tail wheel (Airglas Part No. # L20500-D501A) sideways, force shall be 3-5 lbs (22.24 Newtons).
2. **CHECK**- Main landing gear skis (if installed) inspect for cracks, excessive wear, fractures and abrasions. Security of spring cylinders. Main ski safety and check cables for security (Airglas Part No.# L20500A-12-1) & (Airglas Part No.# L20500A-11).
3. **CHECK** – Main landing gear ski tail wheel spring for damage and security (Airglas Part No. # L20500-D501A).
4. **CHECK**- Tail landing gear skis (if installed) inspect for cracks, excessive wear, fractures and abrasions. Security of the spring cylinder (Airglas Part No. # L20500A-15, Boeing Part No.# 7-511210303-003). Security of the safety cable No. (Airglas Part No. # L20500A-17). Security of the tail wheel assembly (Airglas Part No. # L20500-18).

Section 9.0 INSPECTION CRITERIA

500-Annual (500 hour or Annual inspection)

1. **INSPECT** – The main landing gear ski (Airglas Part No.# L20500A-01) for excessive cracks, wear, fractures and abrasions. Inspect the bottom for cracks, scratches and excess wear. If damaged consult manufacturer. Lubricate tail wheel fittings with SuperLube Synthetic Grease (PTFE).
2. **INSPECT** – The tail landing gear ski (Airglas Part No.# L20500A-03) for excessive cracks, wear, fractures and abrasions. Inspect the bottom for cracks, scratches and excess wear. If damaged consult manufacturer. Lubricate tail wheel fittings with SuperLube Synthetic Grease (PTFE).
3. **INSPECT** – The main landing gear safety cable (Airglas Part No.# L20500A-12) for integrity and fraying. The main landing gear check cable (Airglas Part No.# L20500A-11) for integrity and fraying. The main landing gear spring cylinder (Airglas Part No.# L20500A-8) for cracks, dents, wear, fractures and abrasions. The main landing gear bracket assembly (Airglas Part No.# L20500A-20 & 21) for integrity, cracks, dents and excessive wear.
4. **INSPECT**- The tail landing gear ski safety cable (Airglas Part No.# L20500A-17) for integrity and fraying. The tail landing gear spring cylinder (Airglas Part No.# L20500A-15) for cracks, dents, wear, fractures and abrasions.
5. **INSPECT**- The main landing gear ski axle (Airglas Part No.# L20500A-7 for cracks, dents and fractures. The main landing gear ski axle assemblies (Airglas Part No.# L20500A-5 and L20500A-6) for cracks, dents, fractures and thread integrity.
6. **INSPECT** –The tail landing gear ski axle adapters (Airglas Part No.# L20500A-13) for cracks, dents and fractures. The two (2) special eyebolts (Airglas Part No.#'s L20500A-24 & L20500A-23) for cracks and integrity.

MAINTENANCE TASKS

Section 10.0 MAINTENANCE TASKS

10.1 TOP SURFACE MAINTENANCE

The surface of the ski has a very durable plastic coating that is not affected by gas or oil or environmental conditions. It may be brightened up with rubbing compound and wax occasionally but should not require painting. (NOTE) Small hairline crack marks may appear in this coating at stress points. These do not affect the strength of the ski in any way and ARE NOT to be considered cracks as they are only in the surface coating and don't extend into the laminate.

10.2 BOTTOM SURFACE MAINTENANCE

1. The Teflon urethane coating allows maximum sliding in all snow conditions. No wax is required. Additional coats may be applied by brush or spray when necessary.
2. When bottom surface becomes excessively scratched or worn, it may be sanded down with a small belt or disc sander and re-coated with a brush application of the graphite filled epoxy resin coating 4B2. This is allowed to cure at room temperature and is then roughed up. Then it is coated with a Teflon urethane coating. A kit for this process is obtainable from manufacturer. If major repairs are necessary, manufacturer can advise on proper procedure.

TYPES OF POSSIBLE DAMAGE

A.) Negligible damage

1. Small nicks, scratches or abraded areas in top or bottom of ski.

B.) Repairable damage

1. **Cracks or fractures** - except in area of ski bushing or spring cylinder attach points. Airglas should be consulted on repairs in this area.
2. **Delamination** - except in area of ski bushing and spring cylinder attach points. Airglas should be consulted on repairs in this area.
3. **Small holes** - max. 2" dia.
4. **Abrasion** - bottom wear due to contact with rocks etc., bottom coatings worn through to glass fibers.
5. **Demolished section** - if under 30% of the area of the ski and it must be confined to forward or aft 1/3 of ski. Consult Airglas for repair.
6. **Major bottom damage** - complete new or partial bottom may be factory installed.

C.) DAMAGE NECESSITATING REPLACEMENT

1. Major damage in area of ski bushings.
2. Damage to more than 30% of area of top of ski. This could be a combination of cracks, fractures, delamination, and demolished sections. This type of damage would be caused from a crash.

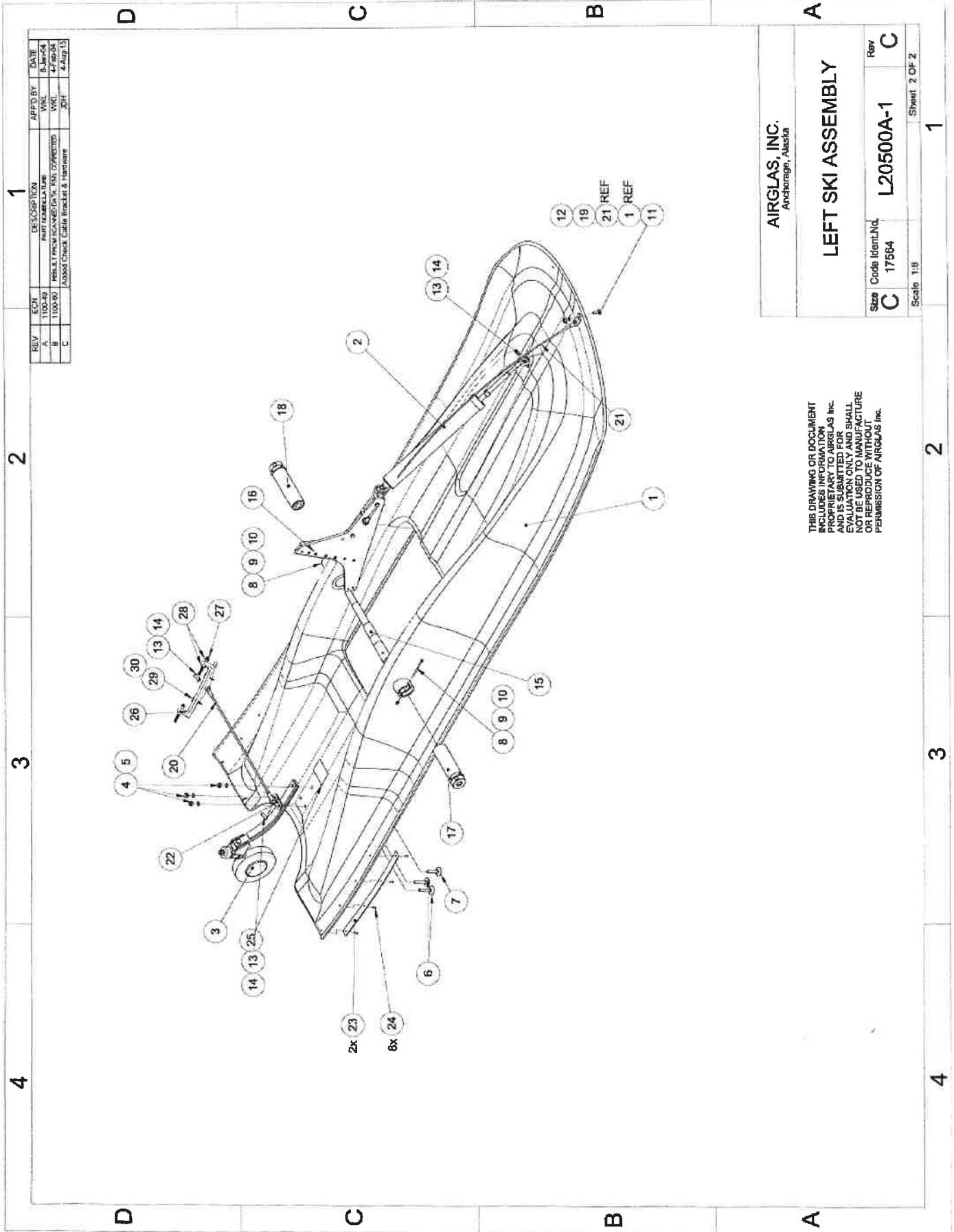

AIRGLAS, INC.
Anchorage, Alaska

LEFT SKI ASSEMBLY

Size	Code IdentNo.	Rev
C	17564	C
Scale 1:8 Sheet 2 OF 2		

THIS DRAWING OR DOCUMENT
INCLUDES INFORMATION
PROPRIETARY TO AIRGLAS INC.
AND IS LOANED TO YOU FOR
EVALUATION ONLY AND SHALL
NOT BE USED TO MANUFACTURE
OR REPRODUCE WITHOUT
PERMISSION OF AIRGLAS INC.

NO.	QTY	CODE-IDENT-NO	PART NO.	DESCRIPTION	STOCK SIZE	MATERIAL
1	1	17564	L20500A-01	MAIN SKI		
2	1	17564	L20500A-8	SPRING CYLINDER, MAIN SKI		
3	1	17564	L20500-D501HD	TAIL WHEEL, ASSY (Heavy Duty)		
4	3		AN363-616	NUT		
5	3		AN960-616L	WASHER		
6	2	17564	EB616-24	ELEVATOR BOLT		
7	1	17564	EB616-22	ELEVATOR BOLT		
8	2		AN3-27A	BOLT		
9	2		AN960-10	WASHER		
10	2		AN365-1032	NUT		
11	1		AN5-6A	BOLT		
12	1		AN365-524	NUT		
13	3		AN396-23	CLEVIS PIN		
14	3		MS24665-302	COTTER PIN		
15	1	17564	L20500A-7	AXLE, MAIN LANDING GEAR		
16	1	17564	L20500A-21	BRACKET ASSEMBLY		
17	1	17564	L20500A-5	AXLE ASSY, INBOARD		
18	1	17564	L20500A-6	AXLE ASSY, OUTBOARD		
19	1		AN960-516L	WASHER		
20	1	17564	L20500A-11	CHECK CABLE		
21	1	17564	L20500A-12	SAFETY CABLE ASSY		
22	1	17564	L20500A-11-1A	SKI ANGLE BRACKET, L.H.		
23	2	17564	L20500-44	MAIN SKI RUNNER / L20500-44HD Is a Heavy Duty R		
24	8		SSB6-10	RIVET / USE AN509-10R-16 or MS24694S8, With MS21C		
25	1	17564		PLACARD		
26	1	17564	L20500A-11-3	CHECK CABLE BRACKET		
27	2		BACB30MT6T33	BOLT		

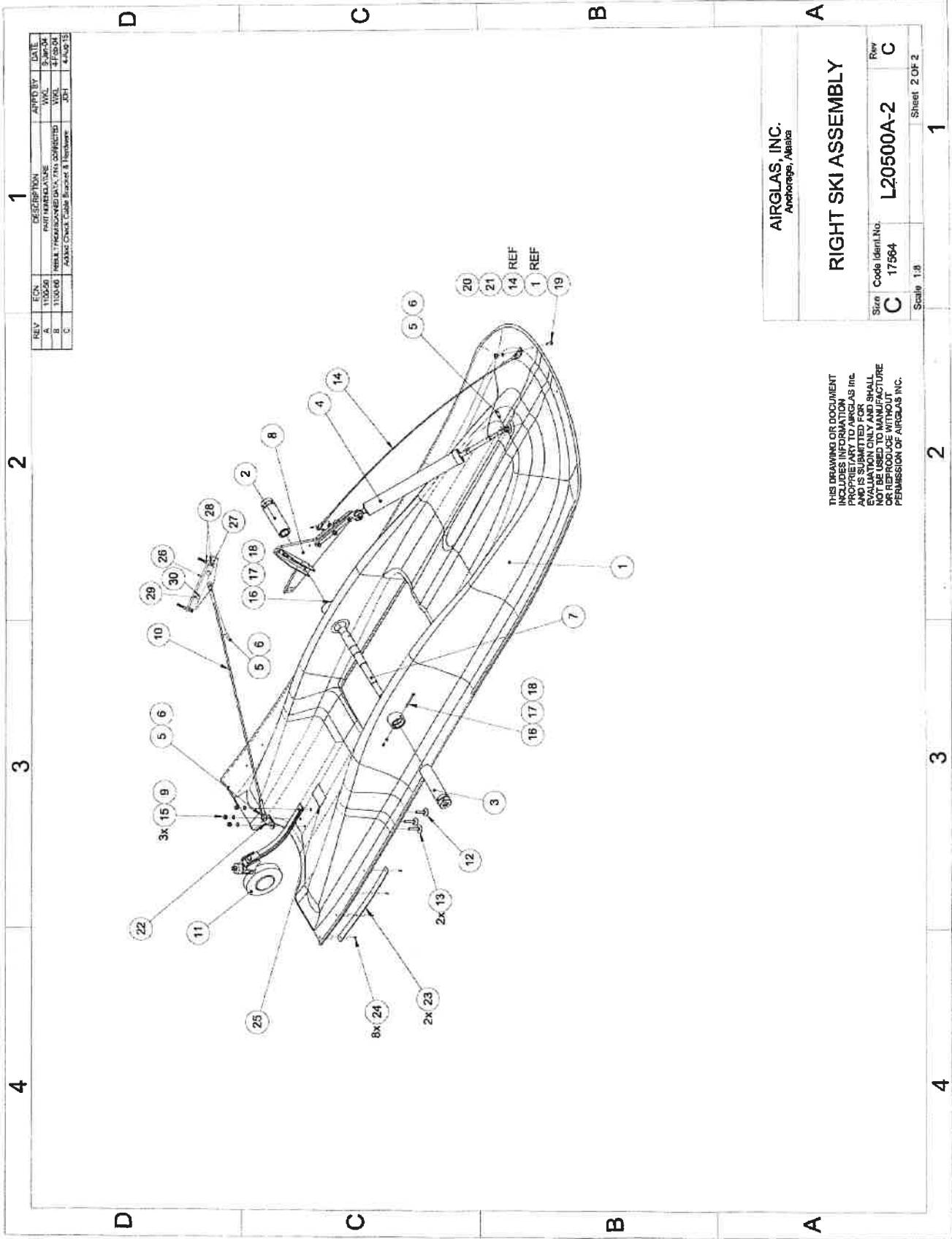

REV	ECN	DESCRIPTION	APPROVED	DATE
A	110050	INITIAL RELEASE	WVL	5-JUN-04
B	110050	REPAIR PROGRAMMED DATA, FWD CONNECTED	WVL	27-SEP-04
C		ADDED CHINESE CABLE BRACKET & HARDWARE	JOH	4-AUG-15

AIRGLAS, INC.
Anchorage, Alaska

RIGHT SKI ASSEMBLY

Size	Code Ident. No.	Rev
C	17564	C
Scale 1:1		Sheet 2 OF 2

THIS DRAWING OR DOCUMENT
INCLUDES INFORMATION
PROPRIETARY TO AIRGLAS INC.
AND IS SUBMITTED FOR
REVIEW ONLY. IT SHALL
NOT BE USED TO MANUFACTURE
OR REPRODUCE WITHOUT
PERMISSION OF AIRGLAS INC.

4

3

2

1

REV	DATE	DESCRIPTION	APPROVED
A	1/15/04	REVISIONS	WKL
B	1/15/04	REVISIONS	WKL
C	1/15/04	REVISIONS	WKL
D	1/15/04	REVISIONS	WKL

WKL: 10/15/03 09:00 AM

10/15/03 09:00 AM

10/15/03 09:00 AM

10/15/03 09:00 AM

10/15/03 09:00 AM

10/15/03 09:00 AM

10/15/03 09:00 AM

10/15/03 09:00 AM

NO.	QTY	CODE	DESCRIPTION	STOCK SIZE	MATERIAL	MATERIAL SPEC	WEIGHT/LBS	FINISH	ZONE
3	1	17564	MAIN SKI						
2	1	17564	AXLE ASSY. INBOARD						
3	1	17564	AXLE ASSY. OUTBOARD						
4	1	17564	SPRING CYLINDER, MAIN SKI						
5	3	17564	COTTER PIN						
6	3	17564	CLEVIS PIN						
7	1	17564	AXLE, MAIN LANDING GEAR						
8	1	17564	BRACKET ASSEMBLY						
9	3	17564	WASHER						
10	1	17564	CHUCK CAM						
11	1	17564	TAIL WHEEL ASSY (Heavy Duty)						
12	1	17564	ELEVATOR BOLT						
13	2	17564	ELEVATOR BOLT						
14	1	17564	SAFETY CABLE ASSY						
15	3	17564	NUT						
16	2	17564	BOLT						
17	2	17564	WASHER						
18	2	17564	NUT						
19	3	17564	BOLT						
20	1	17564	NUT						
21	3	17564	WASHER						
22	1	17564	SKI ANGLE BRACKET, R/L						
23	2	17564	MAIN SKI RUNNER / L20500-44HD is a Heavy Duty Runner. L20500-44HD has countersunk holes in it.						
24	8	17564	RIVET / USE AN509-10R-14 or MS24646-3, WITH MS21042-3 NUT on Heavy Duty Runner						
25	1	17564	PLACARD						
26	1	17564	Check Cable Bracket						
27	2	17564	BOLT						
28	4	17564	WASHER, BEVELED						
29	2	17564	SS LEVELER						
30	3	17564	NUT						

UNLESS OTHERWISE SPECIFIED
DIMENSIONS ARE IN INCHES
TOLERANCES EXCEPT AS NOTED:
FRACTIONS DECIMALS ANGLES
1/16 1/32 1/64 1/8 1/4 1/2 3/4 1 1 1/2 2 3 4 5 6 8 10 12 14 16 18 20 22 24 26 28 30 32 34 36 38 40 42 44 46 48 50 52 54 56 58 60 62 64 66 68 70 72 74 76 78 80 82 84 86 88 90 92 94 96 98 100 102 104 106 108 110 112 114 116 118 120 122 124 126 128 130 132 134 136 138 140 142 144 146 148 150 152 154 156 158 160 162 164 166 168 170 172 174 176 178 180 182 184 186 188 190 192 194 196 198 200 202 204 206 208 210 212 214 216 218 220 222 224 226 228 230 232 234 236 238 240 242 244 246 248 250 252 254 256 258 260 262 264 266 268 270 272 274 276 278 280 282 284 286 288 290 292 294 296 298 300 302 304 306 308 310 312 314 316 318 320 322 324 326 328 330 332 334 336 338 340 342 344 346 348 350 352 354 356 358 360 362 364 366 368 370 372 374 376 378 380 382 384 386 388 390 392 394 396 398 400 402 404 406 408 410 412 414 416 418 420 422 424 426 428 430 432 434 436 438 440 442 444 446 448 450 452 454 456 458 460 462 464 466 468 470 472 474 476 478 480 482 484 486 488 490 492 494 496 498 500 502 504 506 508 510 512 514 516 518 520 522 524 526 528 530 532 534 536 538 540 542 544 546 548 550 552 554 556 558 560 562 564 566 568 570 572 574 576 578 580 582 584 586 588 590 592 594 596 598 600 602 604 606 608 610 612 614 616 618 620 622 624 626 628 630 632 634 636 638 640 642 644 646 648 650 652 654 656 658 660 662 664 666 668 670 672 674 676 678 680 682 684 686 688 690 692 694 696 698 700 702 704 706 708 710 712 714 716 718 720 722 724 726 728 730 732 734 736 738 740 742 744 746 748 750 752 754 756 758 760 762 764 766 768 770 772 774 776 778 780 782 784 786 788 790 792 794 796 798 800 802 804 806 808 810 812 814 816 818 820 822 824 826 828 830 832 834 836 838 840 842 844 846 848 850 852 854 856 858 860 862 864 866 868 870 872 874 876 878 880 882 884 886 888 890 892 894 896 898 900 902 904 906 908 910 912 914 916 918 920 922 924 926 928 930 932 934 936 938 940 942 944 946 948 950 952 954 956 958 960 962 964 966 968 970 972 974 976 978 980 982 984 986 988 990 992 994 996 998 1000 1002 1004 1006 1008 1010 1012 1014 1016 1018 1020 1022 1024 1026 1028 1030 1032 1034 1036 1038 1040 1042 1044 1046 1048 1050 1052 1054 1056 1058 1060 1062 1064 1066 1068 1070 1072 1074 1076 1078 1080 1082 1084 1086 1088 1090 1092 1094 1096 1098 1100 1102 1104 1106 1108 1110 1112 1114 1116 1118 1120 1122 1124 1126 1128 1130 1132 1134 1136 1138 1140 1142 1144 1146 1148 1150 1152 1154 1156 1158 1160 1162 1164 1166 1168 1170 1172 1174 1176 1178 1180 1182 1184 1186 1188 1190 1192 1194 1196 1198 1200 1202 1204 1206 1208 1210 1212 1214 1216 1218 1220 1222 1224 1226 1228 1230 1232 1234 1236 1238 1240 1242 1244 1246 1248 1250 1252 1254 1256 1258 1260 1262 1264 1266 1268 1270 1272 1274 1276 1278 1280 1282 1284 1286 1288 1290 1292 1294 1296 1298 1300 1302 1304 1306 1308 1310 1312 1314 1316 1318 1320 1322 1324 1326 1328 1330 1332 1334 1336 1338 1340 1342 1344 1346 1348 1350 1352 1354 1356 1358 1360 1362 1364 1366 1368 1370 1372 1374 1376 1378 1380 1382 1384 1386 1388 1390 1392 1394 1396 1398 1400 1402 1404 1406 1408 1410 1412 1414 1416 1418 1420 1422 1424 1426 1428 1430 1432 1434 1436 1438 1440 1442 1444 1446 1448 1450 1452 1454 1456 1458 1460 1462 1464 1466 1468 1470 1472 1474 1476 1478 1480 1482 1484 1486 1488 1490 1492 1494 1496 1498 1500 1502 1504 1506 1508 1510 1512 1514 1516 1518 1520 1522 1524 1526 1528 1530 1532 1534 1536 1538 1540 1542 1544 1546 1548 1550 1552 1554 1556 1558 1560 1562 1564 1566 1568 1570 1572 1574 1576 1578 1580 1582 1584 1586 1588 1590 1592 1594 1596 1598 1600 1602 1604 1606 1608 1610 1612 1614 1616 1618 1620 1622 1624 1626 1628 1630 1632 1634 1636 1638 1640 1642 1644 1646 1648 1650 1652 1654 1656 1658 1660 1662 1664 1666 1668 1670 1672 1674 1676 1678 1680 1682 1684 1686 1688 1690 1692 1694 1696 1698 1700 1702 1704 1706 1708 1710 1712 1714 1716 1718 1720 1722 1724 1726 1728 1730 1732 1734 1736 1738 1740 1742 1744 1746 1748 1750 1752 1754 1756 1758 1760 1762 1764 1766 1768 1770 1772 1774 1776 1778 1780 1782 1784 1786 1788 1790 1792 1794 1796 1798 1800 1802 1804 1806 1808 1810 1812 1814 1816 1818 1820 1822 1824 1826 1828 1830 1832 1834 1836 1838 1840 1842 1844 1846 1848 1850 1852 1854 1856 1858 1860 1862 1864 1866 1868 1870 1872 1874 1876 1878 1880 1882 1884 1886 1888 1890 1892 1894 1896 1898 1900 1902 1904 1906 1908 1910 1912 1914 1916 1918 1920 1922 1924 1926 1928 1930 1932 1934 1936 1938 1940 1942 1944 1946 1948 1950 1952 1954 1956 1958 1960 1962 1964 1966 1968 1970 1972 1974 1976 1978 1980 1982 1984 1986 1988 1990 1992 1994 1996 1998 2000 2002 2004 2006 2008 2010 2012 2014 2016 2018 2020 2022 2024 2026 2028 2030 2032 2034 2036 2038 2040 2042 2044 2046 2048 2050 2052 2054 2056 2058 2060 2062 2064 2066 2068 2070 2072 2074 2076 2078 2080 2082 2084 2086 2088 2090 2092 2094 2096 2098 2100 2102 2104 2106 2108 2110 2112 2114 2116 2118 2120 2122 2124 2126 2128 2130 2132 2134 2136 2138 2140 2142 2144 2146 2148 2150 2152 2154 2156 2158 2160 2162 2164 2166 2168 2170 2172 2174 2176 2178 2180 2182 2184 2186 2188 2190 2192 2194 2196 2198 2200 2202 2204 2206 2208 2210 2212 2214 2216 2218 2220 2222 2224 2226 2228 2230 2232 2234 2236 2238 2240 2242 2244 2246 2248 2250 2252 2254 2256 2258 2260 2262 2264 2266 2268 2270 2272 2274 2276 2278 2280 2282 2284 2286 2288 2290 2292 2294 2296 2298 2300 2302 2304 2306 2308 2310 2312 2314 2316 2318 2320 2322 2324 2326 2328 2330 2332 2334 2336 2338 2340 2342 2344 2346 2348 2350 2352 2354 2356 2358 2360 2362 2364 2366 2368 2370 2372 2374 2376 2378 2380 2382 2384 2386 2388 2390 2392 2394 2396 2398 2400 2402 2404 2406 2408 2410 2412 2414 2416 2418 2420 2422 2424 2426 2428 2430 2432 2434 2436 2438 2440 2442 2444 2446 2448 2450 2452 2454 2456 2458 2460 2462 2464 2466 2468 2470 2472 2474 2476 2478 2480 2482 2484 2486 2488 2490 2492 2494 2496 2498 2500 2502 2504 2506 2508 2510 2512 2514 2516 2518 2520 2522 2524 2526 2528 2530 2532 2534 2536 2538 2540 2542 2544 2546 2548 2550 2552 2554 2556 2558 2560 2562 2564 2566 2568 2570 2572 2574 2576 2578 2580 2582 2584 2586 2588 2590 2592 2594 2596 2598 2600 2602 2604 2606 2608 2610 2612 2614 2616 2618 2620 2622 2624 2626 2628 2630 2632 2634 2636 2638 2640 2642 2644 2646 2648 2650 2652 2654 2656 2658 2660 2662 2664 2666 2668 2670 2672 2674 2676 2678 2680 2682 2684 2686 2688 2690 2692 2694 2696 2698 2700 2702 2704 2706 2708 2710 2712 2714 2716 2718 2720 2722 2724 2726 2728 2730 2732 2734 2736 2738 2740 2742 2744 2746 2748 2750 2752 2754 2756 2758 2760 2762 2764 2766 2768 2770 2772 2774 2776 2778 2780 2782 2784 2786 2788 2790 2792 2794 2796 2798 2800 2802 2804 2806 2808 2810 2812 2814 2816 2818 2820 2822 2824 2826 2828 2830 2832 2834 2836 2838 2840 2842 2844 2846 2848 2850 2852 2854 2856 2858 2860 2862 2864 2866 2868 2870 2872 2874 2876 2878 2880 2882 2884 2886 2888 2890 2892 2894 2896 2898 2900 2902 2904 2906 2908 2910 2912 2914 2916 2918 2920 2922 2924 2926 2928 2930 2932 2934 2936 2938 2940 2942 2944 2946 2948 2950 2952 2954 2956 2958 2960 2962 2964 2966 2968 2970 2972 2974 2976 2978 2980 2982 2984 2986 2988 2990 2992 2994 2996 2998 3000 3002 3004 3006 3008 3010 3012 3014 3016 3018 3020 3022 3024 3026 3028 3030 3032 3034 3036 3038 3040 3042 3044 3046 3048 3050 3052 3054 3056 3058 3060 3062 3064 3066 3068 3070 3072 3074 3076 3078 3080 3082 3084 3086 3088 3090 3092 3094 3096 3098 3100 3102 3104 3106 3108 3110 3112 3114 3116 3118 3120 3122 3124 3126 3128 3130 3132 3134 3136 3138 3140 3142 3144 3146 3148 3150 3152 3154 3156 3158 3160 3162 3164 3166 3168 3170 3172 3174 3176 3178 3180 3182 3184 3186 3188 3190 3192 3194 3196 3198 3200 3202 3204 3206 3208 3210 3212 3214 3216 3218 3220 3222 3224 3226 3228 3230 3232 3234 3236 3238 3240 3242 3244 3246 3248 3250 3252 3254 3256 3258 3260 3262 3264 3266 3268 3270 3272 3274 3276 3278 3280 3282 3284 3286 3288 3290 3292 3294 3296 3298 3300 3302 3304 3306 3308 3310 3312 3314 3316 3318 3320 3322 3324 3326 3328 3330 3332 3334 3336 3338 3340 3342 3344 3346 3348 3350 3352 3354 3356 3358 3360 3362 3364 3366 3368 3370 3372 3374 3376 3378 3380 3382 3384 3386 3388 3390 3392 3394 3396 3398 3400 3402 3404 3406 3408 3410 3412 3414 3416 3418 3420 3422 3424 3426 3428 3430 3432 3434 3436 3438 3440 3442 3444 3446 3448 3450 3452 3454 3456 3458 3460 3462 3464 3466 3468 3470 3472 3474 3476 3478 3480 3482 3484 3486 3488 3490 3492 3494 3496 3498 3500 3502 3504 3506 3508 3510 3512 3514 3516 3518 3520 3522 3524 3526 3528 3530 3532 3534 3536 3538 3540 3542 3544 3546 3548 3550 3552 3554 3556 3558 3560 3562 3564 3566 3568 3570 3572 3574 3576 3578 3580 3582 3584 3586 3588 3590 3592 3594 3596 3598 3600 3602 3604 3606 3608 3610 3612 3614 3616 3618 3620 3622 3624 3626 3628 3630 3632 3634 3636 3638 3640 3642 3644 3646 3648 3650 3652 3654 3656 3658 3660 3662 3664 3666 3668 3670 3672 3674 3676 3678 3680 3682 3684 3686 3688 3690 3692 3694 3696 3698 3700 3702 3704 3706 3708 3710 3712 3714 3716 3718 3720 3722 3724 3726 3728 3730 3732 3734 3736 3738 3740 3742 3744 3746 3748 3750 3752 3754 3756 3758 3760 3762 3764 3766 3768 3770 3772 3774 3776 3778 3780 3782 3784 3786 3788 3790 3792 3794 3796 3798 3800 3802 3804 3806 3808 3810 3812 3814 3816 3818 3820 3822 3824 3826 3828 3830 3832 3834 3836 3838 3840 3842 3844 3846 3848 3850 3852 3854 3856 3858 3860 3862 3864 3866 3868 3870 3872 3874 3876 3878 3880 3882 3884 3886 3888 3890 3892 3894 3896 3898 3900 3902 3904 3906 3908 3910 3912 3914 3916 3918 3920 3922 3924 3926 3928 3930 3932 3934 3936 3938 3940 3942 3944 3946 3948 3950 3952 3954 3956 3958 3960 3962 3964 3966 3968 3970 3972 3974 3976 3978 3980 3982 3984 3986 3988 3990 3992 3994 3996 3998 4000 4002 4004 4006 4008 4010 4012 4014 4016 4

REV	DATE	BY	CHKD	APP'D
1	11/01/01	11/01/01	11/01/01	11/01/01
2	11/01/01	11/01/01	11/01/01	11/01/01
3	11/01/01	11/01/01	11/01/01	11/01/01
4	11/01/01	11/01/01	11/01/01	11/01/01
5	11/01/01	11/01/01	11/01/01	11/01/01
6	11/01/01	11/01/01	11/01/01	11/01/01
7	11/01/01	11/01/01	11/01/01	11/01/01
8	11/01/01	11/01/01	11/01/01	11/01/01
9	11/01/01	11/01/01	11/01/01	11/01/01
10	11/01/01	11/01/01	11/01/01	11/01/01
11	11/01/01	11/01/01	11/01/01	11/01/01
12	11/01/01	11/01/01	11/01/01	11/01/01
13	11/01/01	11/01/01	11/01/01	11/01/01
14	11/01/01	11/01/01	11/01/01	11/01/01
15	11/01/01	11/01/01	11/01/01	11/01/01
16	11/01/01	11/01/01	11/01/01	11/01/01
17	11/01/01	11/01/01	11/01/01	11/01/01
18	11/01/01	11/01/01	11/01/01	11/01/01
19	11/01/01	11/01/01	11/01/01	11/01/01
20	11/01/01	11/01/01	11/01/01	11/01/01
21	11/01/01	11/01/01	11/01/01	11/01/01
22	11/01/01	11/01/01	11/01/01	11/01/01
23	11/01/01	11/01/01	11/01/01	11/01/01
24	11/01/01	11/01/01	11/01/01	11/01/01
25	11/01/01	11/01/01	11/01/01	11/01/01
26	11/01/01	11/01/01	11/01/01	11/01/01
27	11/01/01	11/01/01	11/01/01	11/01/01
28	11/01/01	11/01/01	11/01/01	11/01/01
29	11/01/01	11/01/01	11/01/01	11/01/01
30	11/01/01	11/01/01	11/01/01	11/01/01
31	11/01/01	11/01/01	11/01/01	11/01/01
32	11/01/01	11/01/01	11/01/01	11/01/01
33	11/01/01	11/01/01	11/01/01	11/01/01
34	11/01/01	11/01/01	11/01/01	11/01/01
35	11/01/01	11/01/01	11/01/01	11/01/01
36	11/01/01	11/01/01	11/01/01	11/01/01
37	11/01/01	11/01/01	11/01/01	11/01/01
38	11/01/01	11/01/01	11/01/01	11/01/01
39	11/01/01	11/01/01	11/01/01	11/01/01
40	11/01/01	11/01/01	11/01/01	11/01/01
41	11/01/01	11/01/01	11/01/01	11/01/01
42	11/01/01	11/01/01	11/01/01	11/01/01
43	11/01/01	11/01/01	11/01/01	11/01/01
44	11/01/01	11/01/01	11/01/01	11/01/01
45	11/01/01	11/01/01	11/01/01	11/01/01
46	11/01/01	11/01/01	11/01/01	11/01/01
47	11/01/01	11/01/01	11/01/01	11/01/01
48	11/01/01	11/01/01	11/01/01	11/01/01
49	11/01/01	11/01/01	11/01/01	11/01/01
50	11/01/01	11/01/01	11/01/01	11/01/01

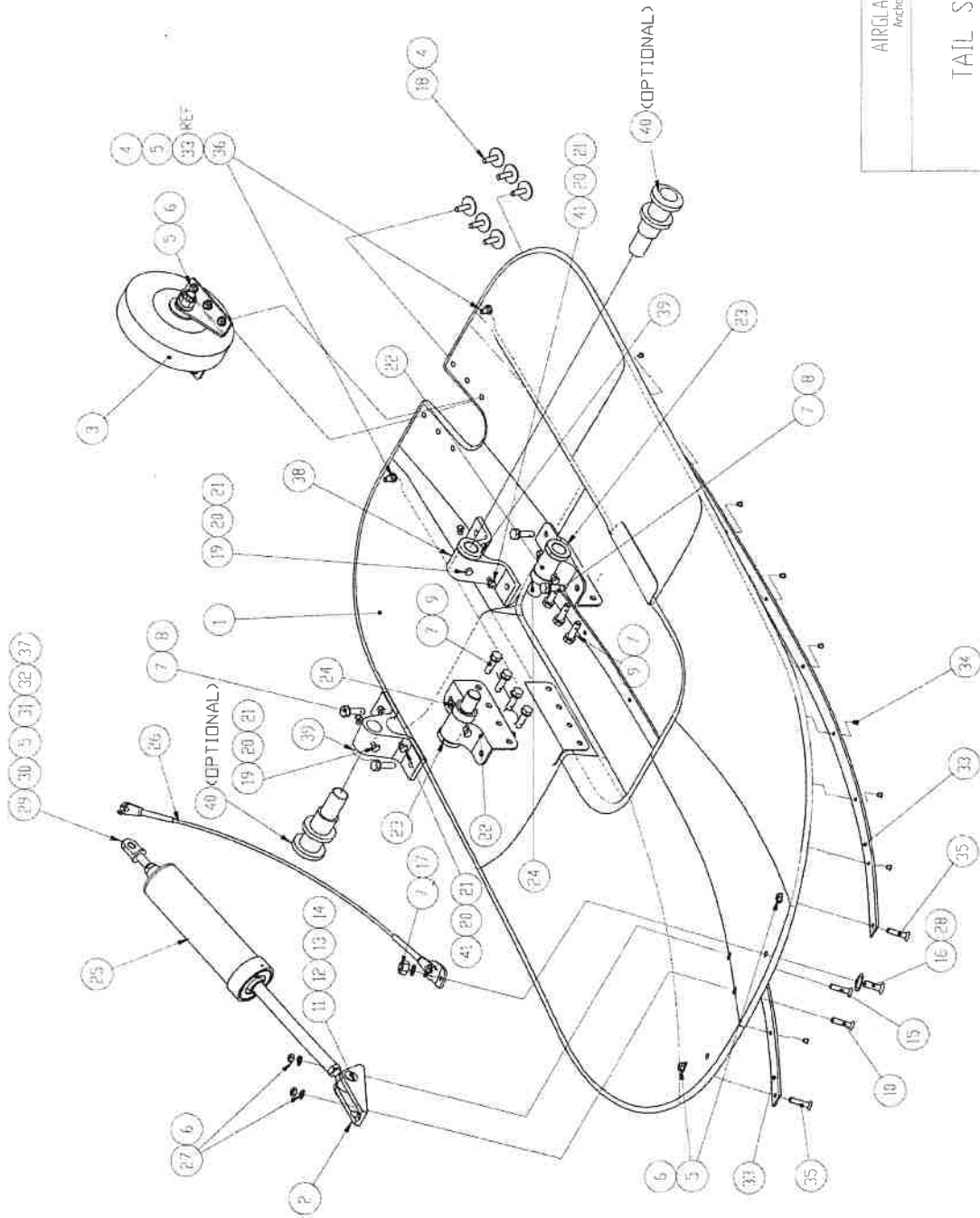

AIRGLAS, INC.
Anchorage, Alaska

TAIL SKI ASSEMBLY

Size	Case Ident.	Rev
C	17564	B
Scale	1:1	Sheet 2 of 2

REMOVAL OF SKISPROCEDURE

The best method to remove the L20500A Ski kit is to remove the Tail Ski (L20500A-3) first.

Tail Ski Removal Procedure:

1. Remove Bolts (AN4-7A), Washers (AN960-416), and Nuts (A365-428), (and NAS70C-4 Washers) holding tail ski, Tail Wheel Bracket Kit (L20500-18) to ski and remove Tail Wheel Bracket Kit. *See Figure 2.0* (retain hardware)
2. Remove Cotter pin (MS24665-151), Washer (AN960-416) and Nut (AN310-4) from Eye Bolt (L20500A-24) attached to TLG wheel fork assembly lugs 1168850.
3. Hold the Spring Cylinder in one hand, lift the front of the ski, and remove the L20500A-24 from TLG lug. Retain the upper Spring Cylinder Eye Bolt (L20500A-23) and Bushings. After removal from the TLG lug, loosely reinstall the L20500A-24 back into the L20500A-23 Eyebolt, using the Washer (AN960-416) and Nut (AN310-4). Note: The Safety cable (L20500A-17) can remain attached to eyebolt (L20500A-24) for storage. *See Figure 6.2*
4. Remove Bolt(s) (AN3-21A) lower bolts of Apache Tow Bar Adapter (L20500A-14-2). Retain Bolt, Washer(s) (AN960-10) and Nut(s) (AN365-1032). *See page 29& 30 of Manual for Breakdown of parts*
5. Remove Tail Ski Axle Adapter(s) (L20500A-13) from Ski Attach Bracket(s), remove Axle Spacer(s) (L20500A-16) on Tail Ski Axle Adapter(s). *See page 29& 30 of Manual for Breakdown of parts*
6. Remove Ski Axle Adapter (s) (L20500A-13) from Tail Ski Axle. Use care in holding up ski during this step.
7. Once ski is completely removed from tail landing gear, connect tow vehicle to standard axle location.
8. Tow helicopter backwards until the wheel rolls over and out of tail ski.
9. Re-Install Tail Wheel Bracket Kit (L20500-18) onto tail ski. *See Figure 2.0*
10. Reinstall a Wire Strike (Deflector) onto Tail Landing Gear using all hardware identified in Helicopters Illustrated Parts Breakdown (IPB).

Main Ski Removal Procedure:

NOTE: Preparation of both skis is the same except where noted.

11. Remove Tail Wheel Assembly and Check Cable from rear of the Main Ski by removing Elevator Bolts (EB616-20, EB616-21) from the bottom of the ski *See figure 1.1* Save all hardware for future use.
12. Remove bolt(s) (AN3-27A) from Inboard and Outboard Axles and Ski Bushing. Retain Washer(s) (AN960-10) and Nut(s) (AN365-1032) onto bolt(s) *See Figure 5.2*.
13. Remove Spring Cylinder, Main Ski (L20500A-8) from Upper Mounting Bracket (L20500A-21-3), retain Clevis Bolt (AN26-25), (2) Washers (AN960-616L) and Nut (AN320-6), (4) Special Washers (P/N 528D378D050 (2 each side of rod end). *See Figure 5.3*
14. Remove upper end of Safety Cable Assy. (L20500A-12) from to Eye Bolt (AN45-11) at 2nd hole back on Bracket Assy. (P/N L20500A-20, L20500A-21) Retain clevis pin (AN395-17) and cotter pin MS249665-302. *See Figure 5.5*
15. Completely remove Axle Assy's., Inboard & Outboard (L20500A-5 & L20500A-6) from Main Ski Bushing Assy. (L20500-4) . Lift Rear of ski to take weight off of axles. *See Figure 5.1* Note: Assistance will be needed to support ski during this operation.
16. Remove Check Cable (L20500A-11) from check cable bracket, PN L20500A-11-3 by removing Clevis Pin and Cotter Pin.
17. Install Airglas installation ramps on both main skis. Ensure all attachments to gear are removed.

18. Tow helicopter or push helicopter aft with help of assistants until the main wheels are completely outside of skis. CAUTION – To avoid damage to ski take extreme care to ensure that the wheels are on the outboard part of the wheel wells. *See Figure 5.0*
19. Re-Install Tail Wheel Assembly (L20500-D501A) *See Figure 1.1*
20. Once ski is removed, continue to remove other hardware as needed. If skis are only removed for maintenance or other issues, all remaining hardware can remain installed on helicopter.

RETURNING AIRCRAFT TO ORIGINAL CONFIGURATION (WITHOUT SKIS)

21. Remove Axle (L20500A-7) from Trailing Arm (1168320-101). Remove bolt, and slide axle out by rotating and pulling on it. Retain existing hardware for later install of Jack Pad (1168321-1) . *See Figure 3.2*
22. Install Jack Pad (1168321-1) and align with Trailing Arm (1168320-101), using hardware from Step 21 above. Torque to value given in Figure 3.2
23. Remove both inboard pylons.
24. Remove inboard attach bolts and check cable bracket (L20500-11-3).
25. Install original HS6170V6-22 bolts back into inboard pylon.
26. Re-install pylon. Match torque of existing pylon bolts.
27. Remove Step Assembly (7-511113527-1 & -2). Keep existing hardware for future use. *See figure 3.0.*
28. Remove Airglas Bracket Assembly (L20500A-20 R.H., L20500A-21 L.H.) to Main Landing Gear, retain existing hardware *See Figure 3.1*
29. Install Wire Cutter Assembly (443-83020-2). *See figure 3.0*, Bolt Wire Cutter to Clamp (443-83023-1) (both sides) using existing hardware from Step 28. *See Figure 3.1*
30. Re-install Step Assembly (7-511113527-1 & -2) to Wire Cutter Assembly using existing hardware from Step 27. *See Figure 3.1 inboard .*